

# Sliding wardrobe City Lite 2250x1200x450 mm

## ASSEMBLY INSTRUCTION

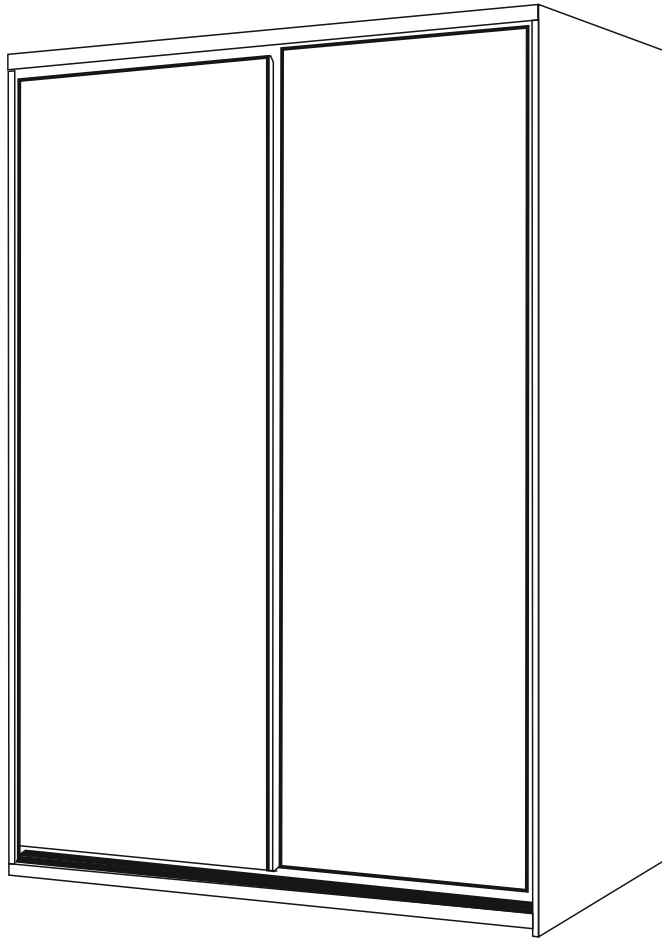

Dimensions  
Height: 2250 mm  
Width: 1200 mm  
Depth: 450 mm



### **NOTE!**

For all questions and complaints about this product, please contact the place of purchase of this product.



### **RULES FOR USE AND CARE OF FURNITURE**

1. Use furniture only in dry rooms protected from the effects of weather conditions.
2. Install with suitable tools according to these assembly instructions.
3. Try to assemble as close to the location as possible.
4. The body is assembling in a horizontal position.
5. Before moving furniture, make sure that it is not loaded with items.

**Caution:** moving furniture may damage it.

When moving, hold on to vertical elements only; moving furniture by horizontal parts can break the product.

6. Overloading the furniture can damage it.
7. From time to time check the fittings and their correct position.
8. Wipe the furniture surface only with a slightly damp cloth or paper towels. Do not use chemical cleaning agents other than those specifically made for this.

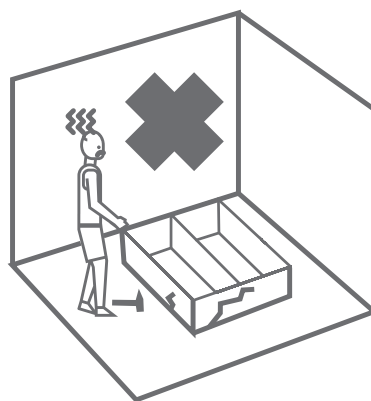
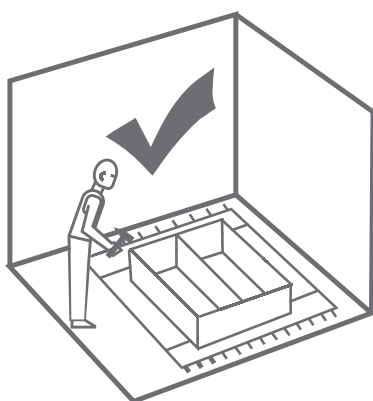
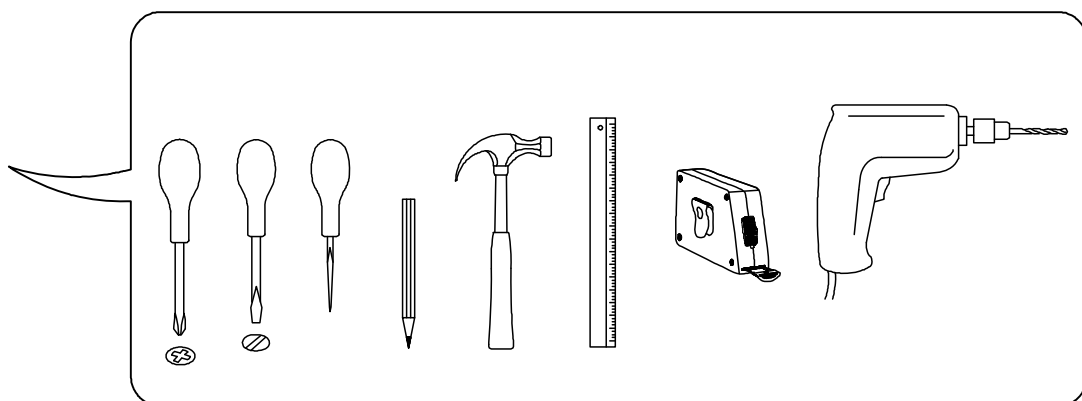

60-120 min

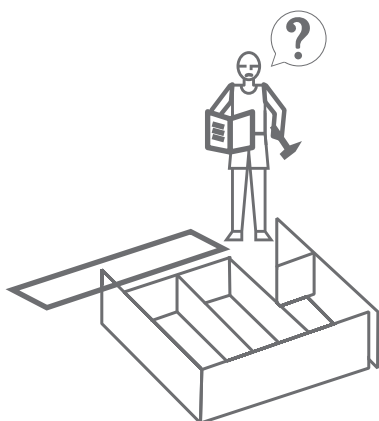
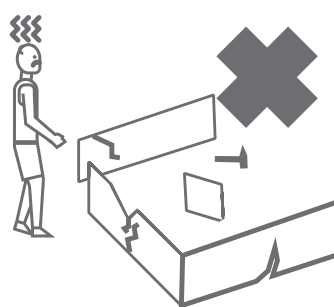
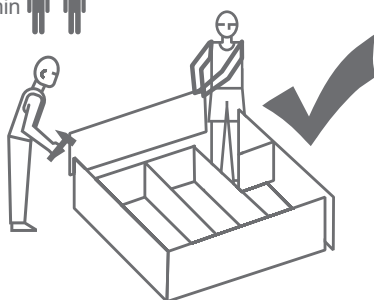

# PARTS LIST

№	Description	Dimensions		№ pack	Qty.
01	Side stand left	2250	448	1/3	1
02	Side stand right	2250	448	1/3	1
03	Inner stand	1772	342	1/3	1
04	Back wall (fiberboard)	2200	397	1/3	3
05	Roof	1168	448	2/3	1
06	Bottom	1168	448	2/3	1
07	Transverse shelf	1168	350	2/3	1
08	Shelf	448	338	2/3	4
09	Bottom located along	1168	46	2/3	2

№	Description	Dimensions		№ pack	Qty.
10	Направляющий профиль верх	1168		2/3	2
11	Двері до шкафи-купе			3/3	2
12	Направляющий профиль низ	1168		2/3	1
13	Цоколь поперечный	370	46	2/3	1

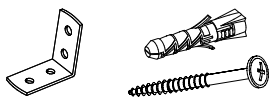
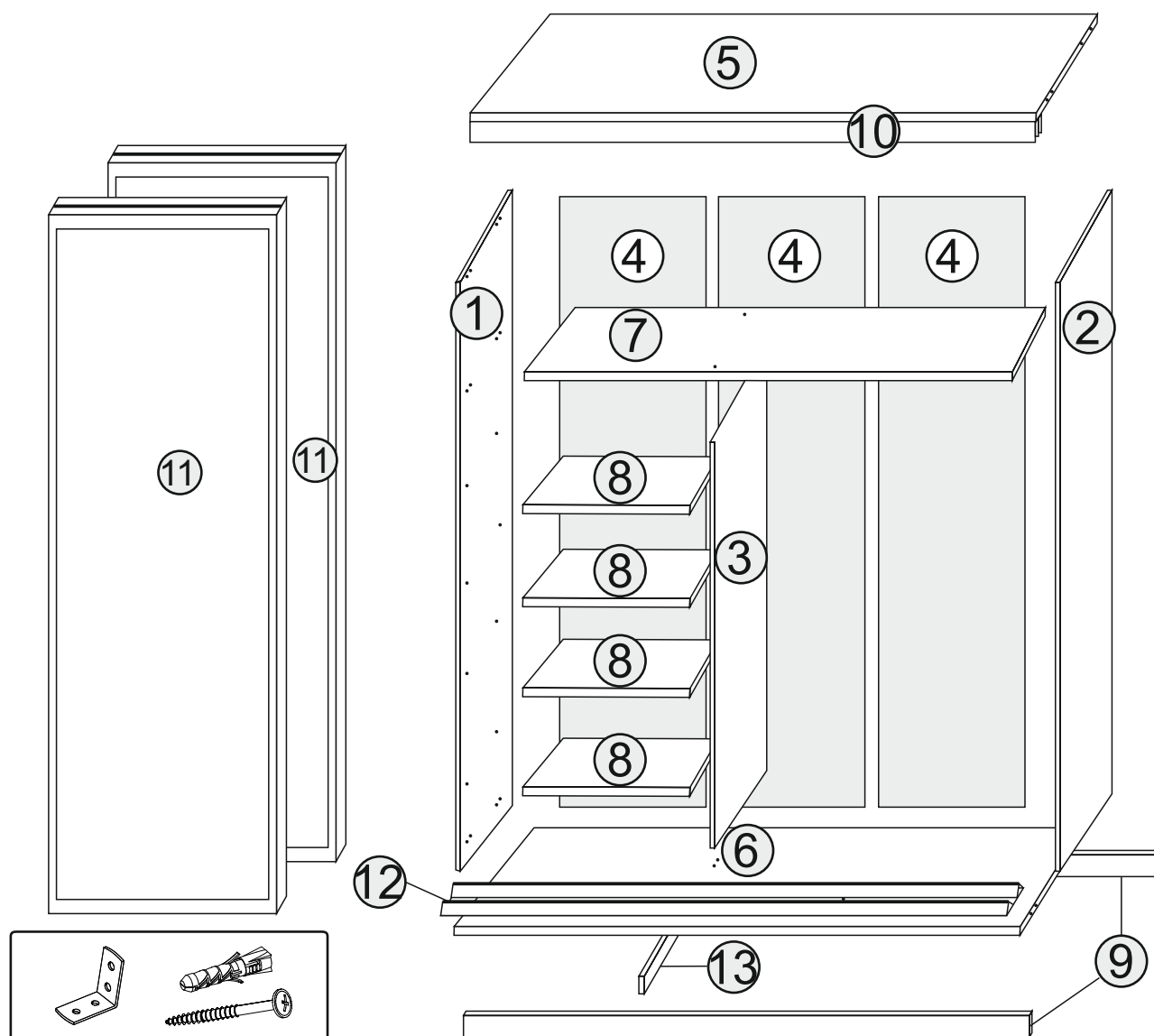

The dowel and the wall mounting angle are not included. Purchase separately.

## Fittings:

2x 	16x  φ5x17 mm d1	40x  φ3,5x16 mm p38	16x  φ5x50 mm e32	16x  φ8x30 mm f1	1x  z1
2x 	6x  k1	 l1	14x  φ16 s2	6x  c1	2x 

# 1

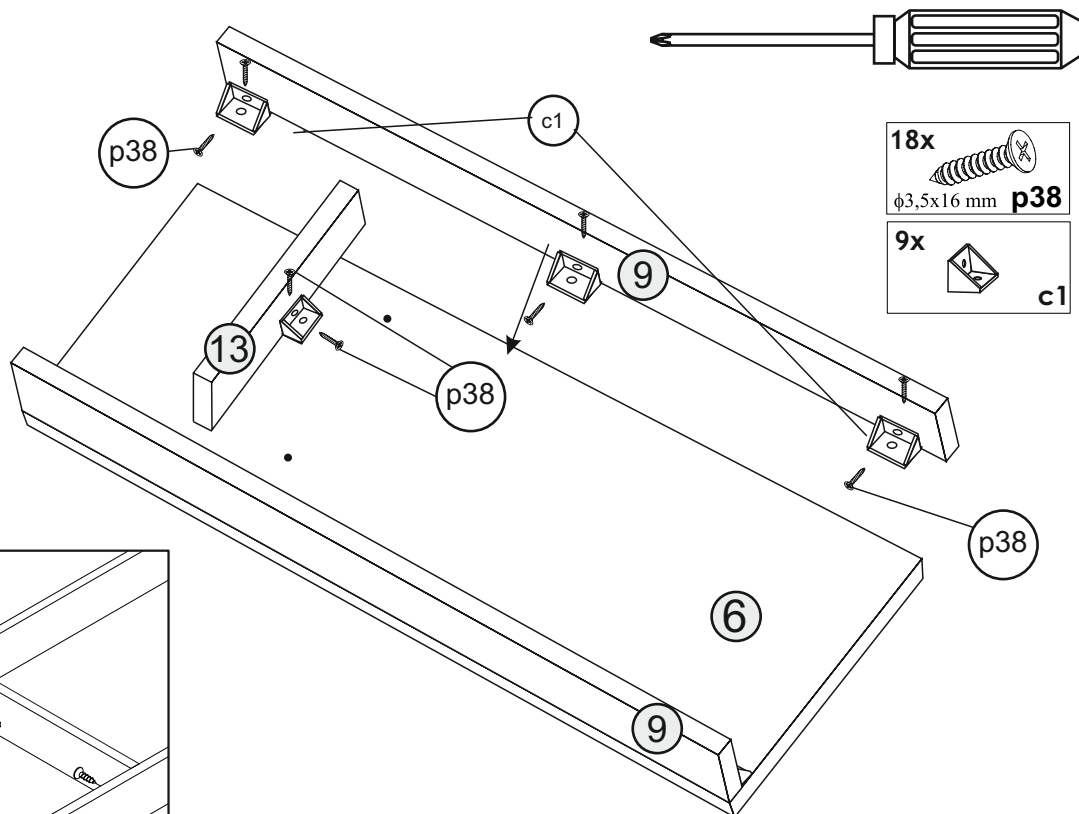

# 2

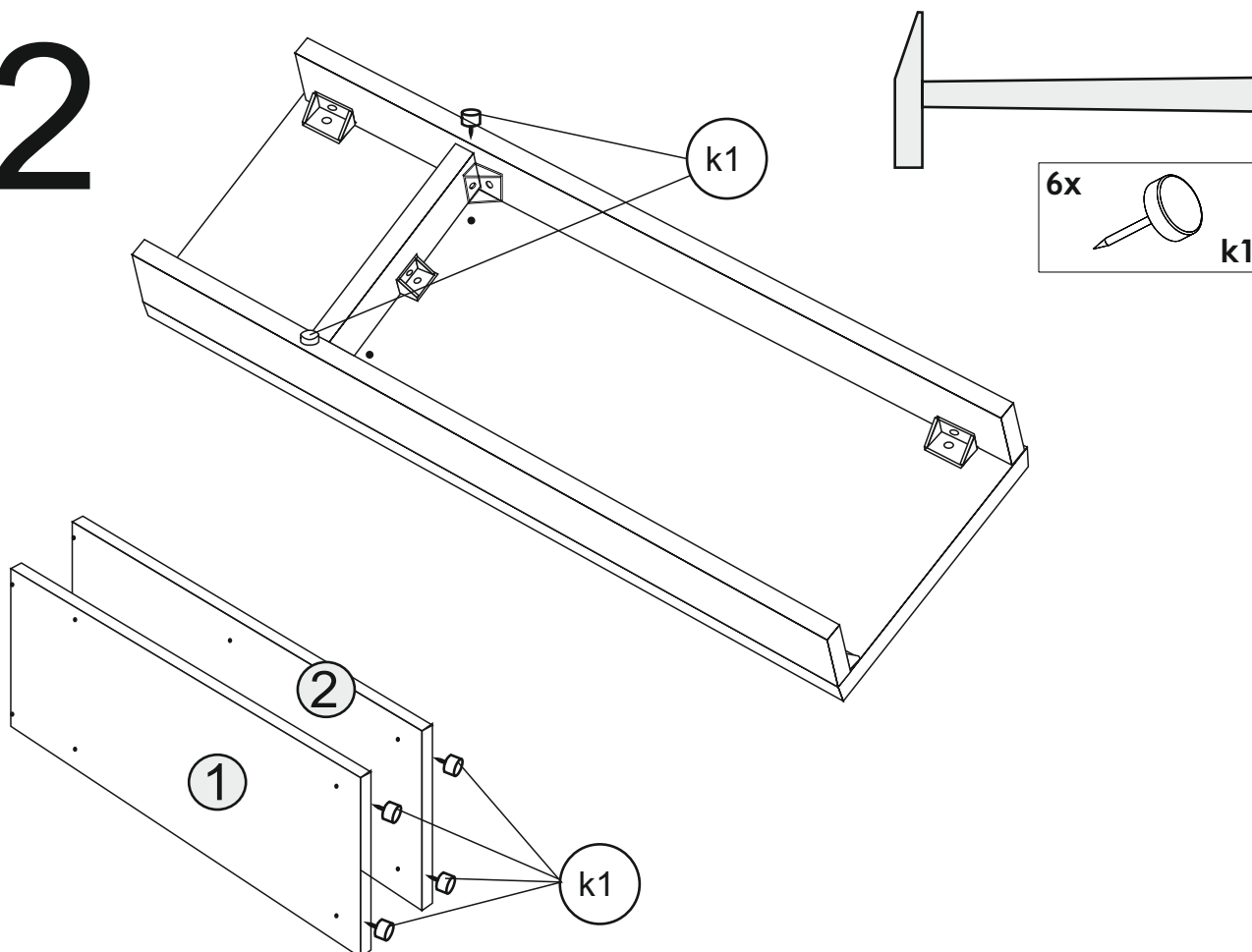

# 3

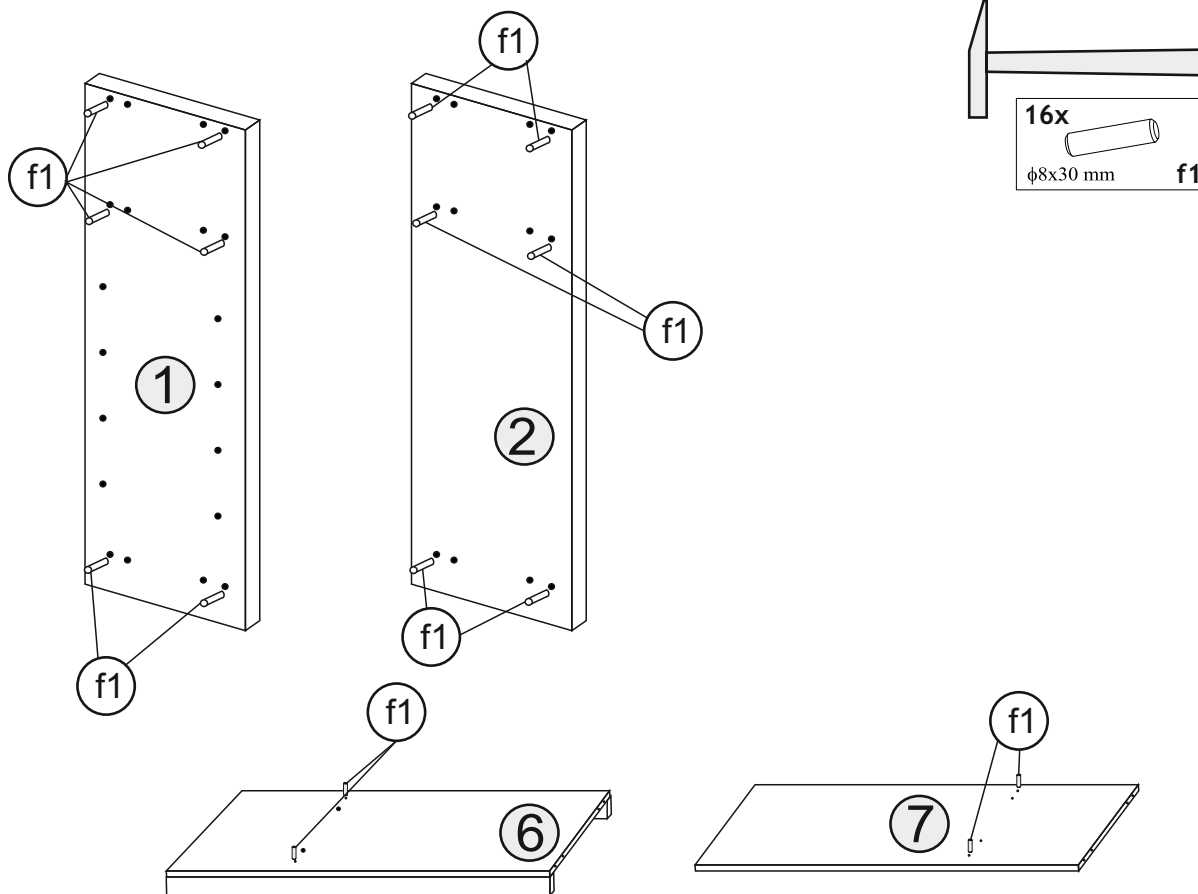

# 4

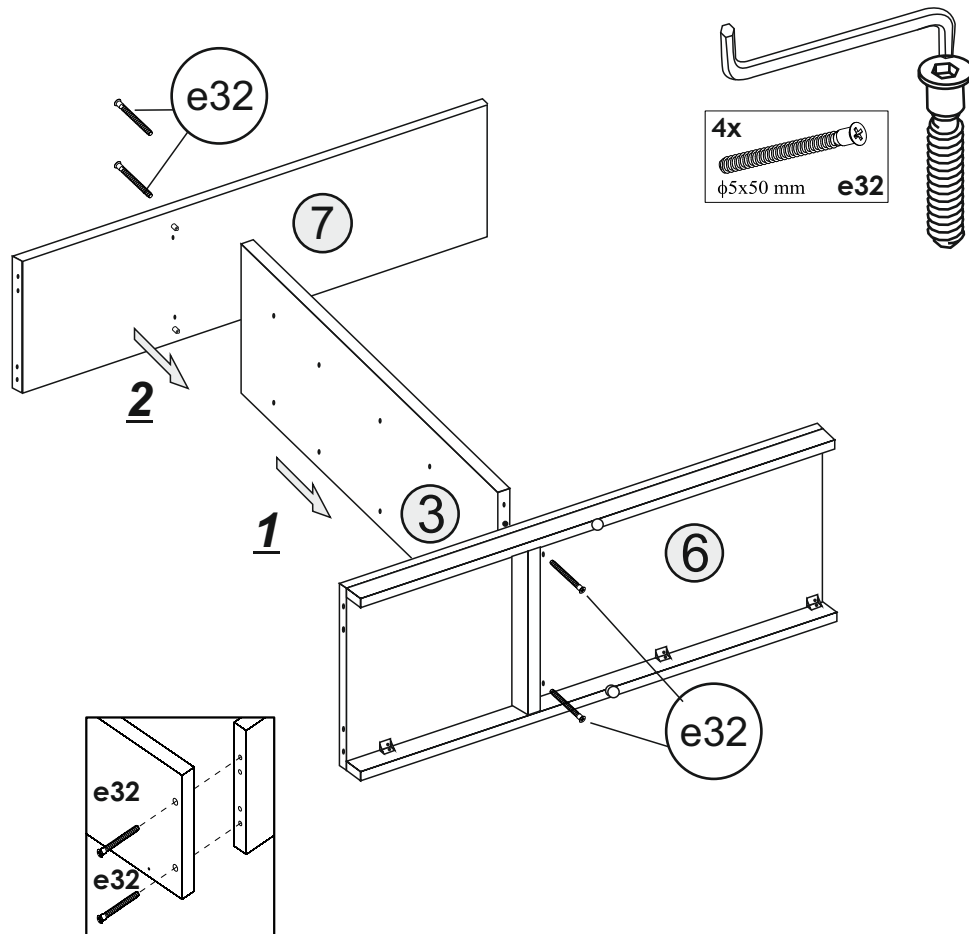

# 5

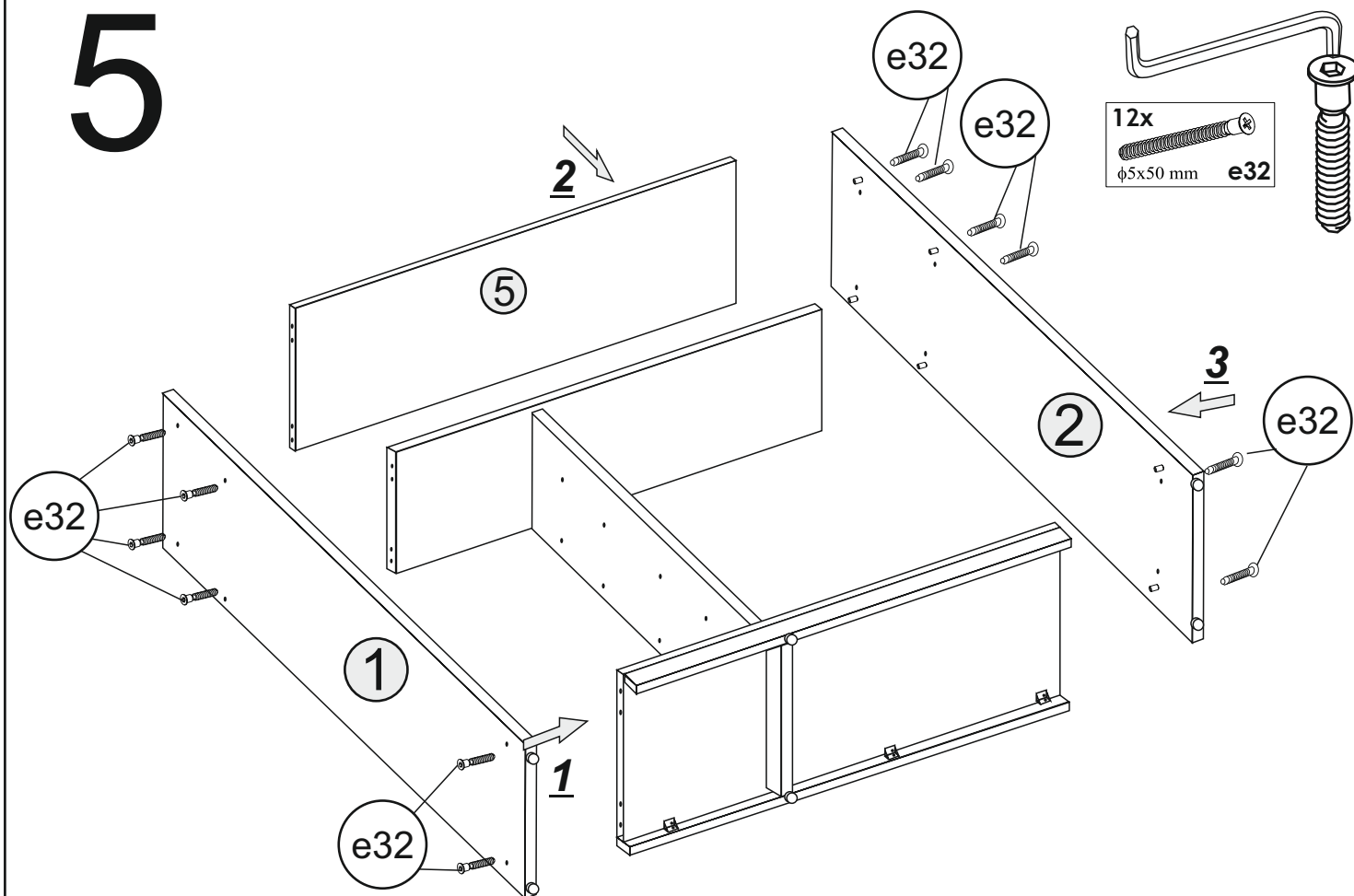

# 6

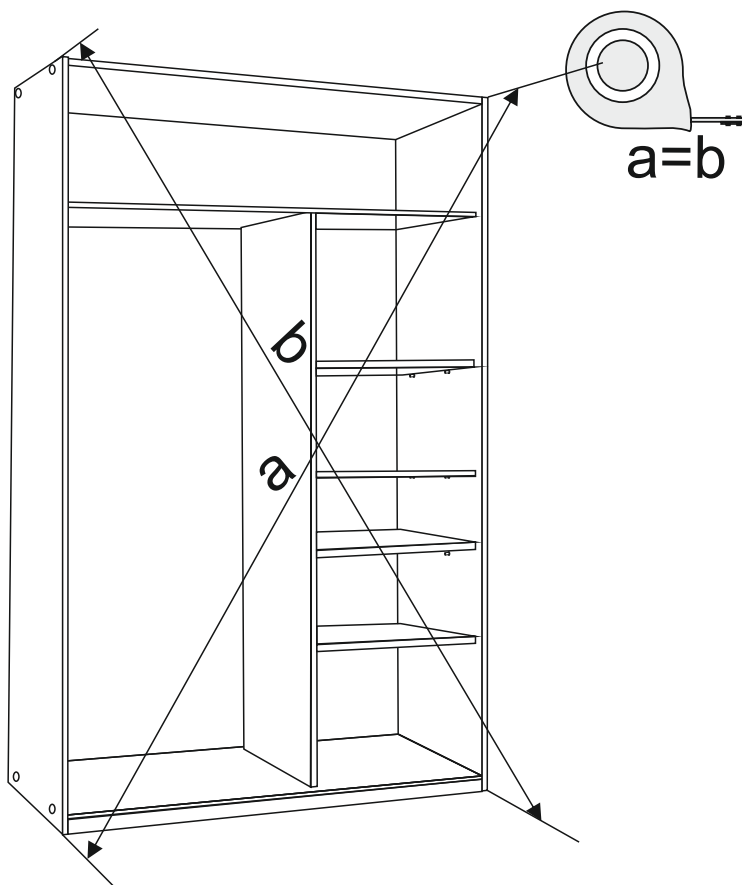

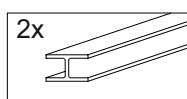
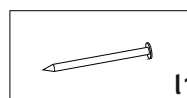
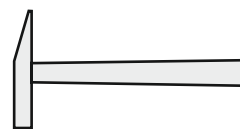
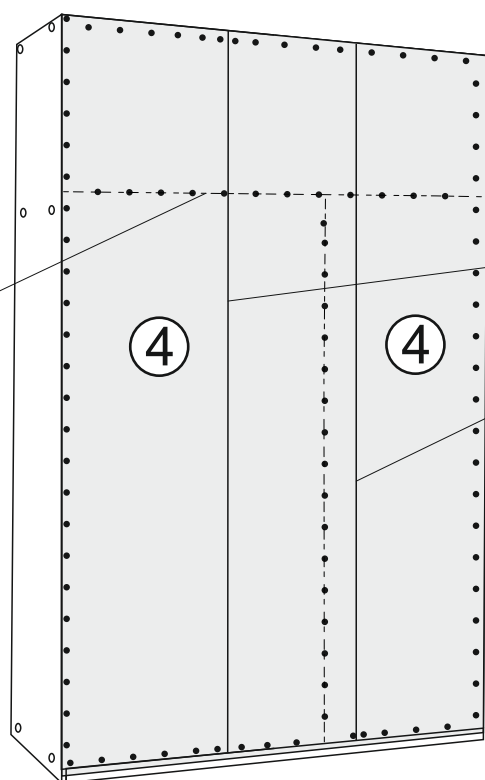

8

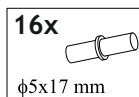

**d'**

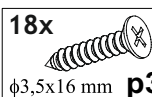

**d'**

φ3,5x16 mm **p38**

2x

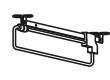

d5

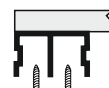

(p38)

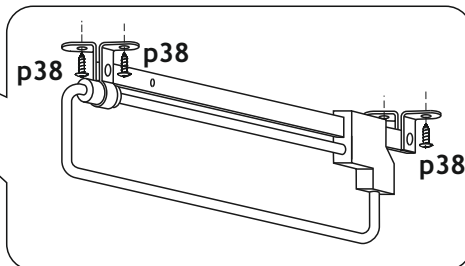
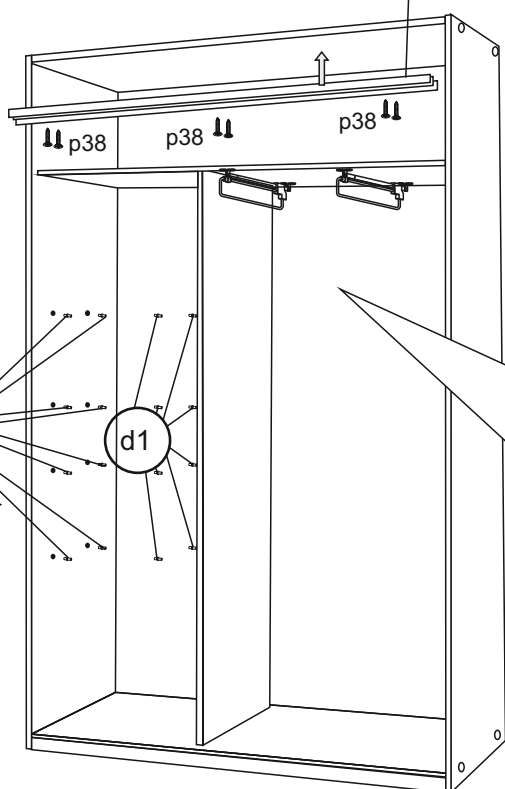
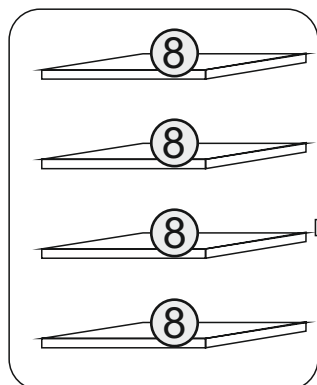

# 9

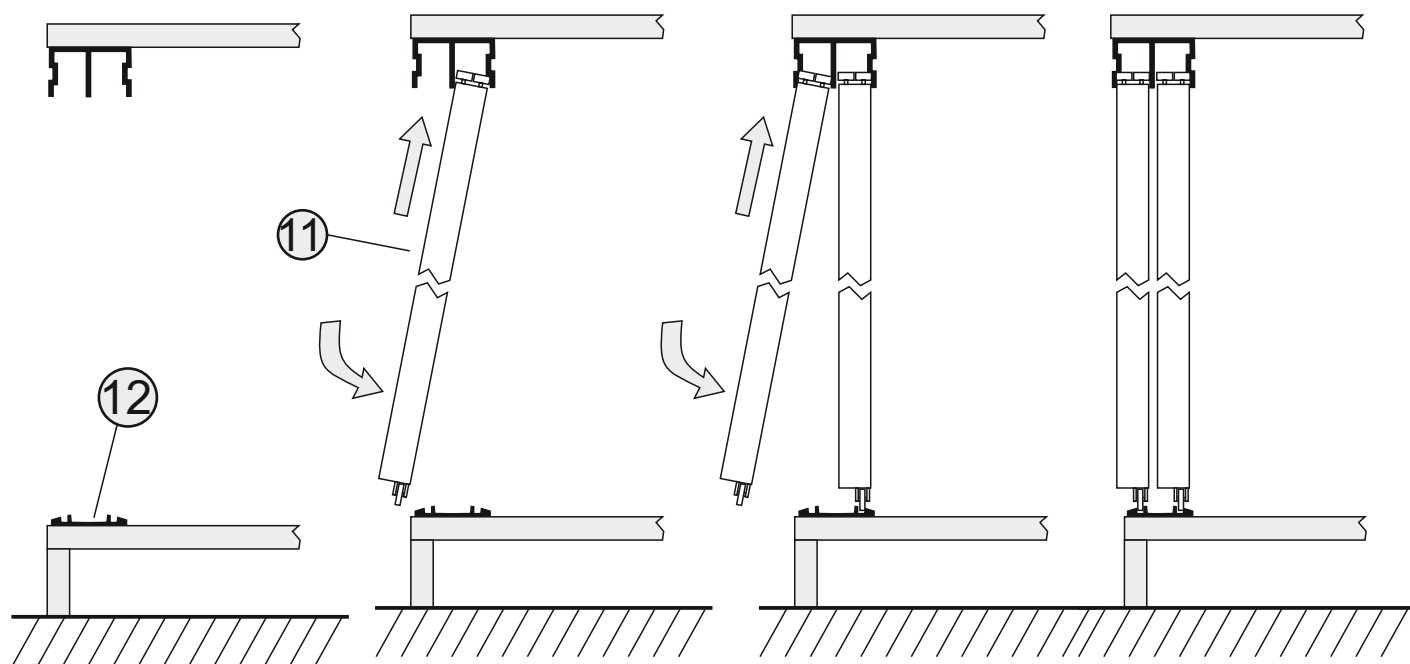
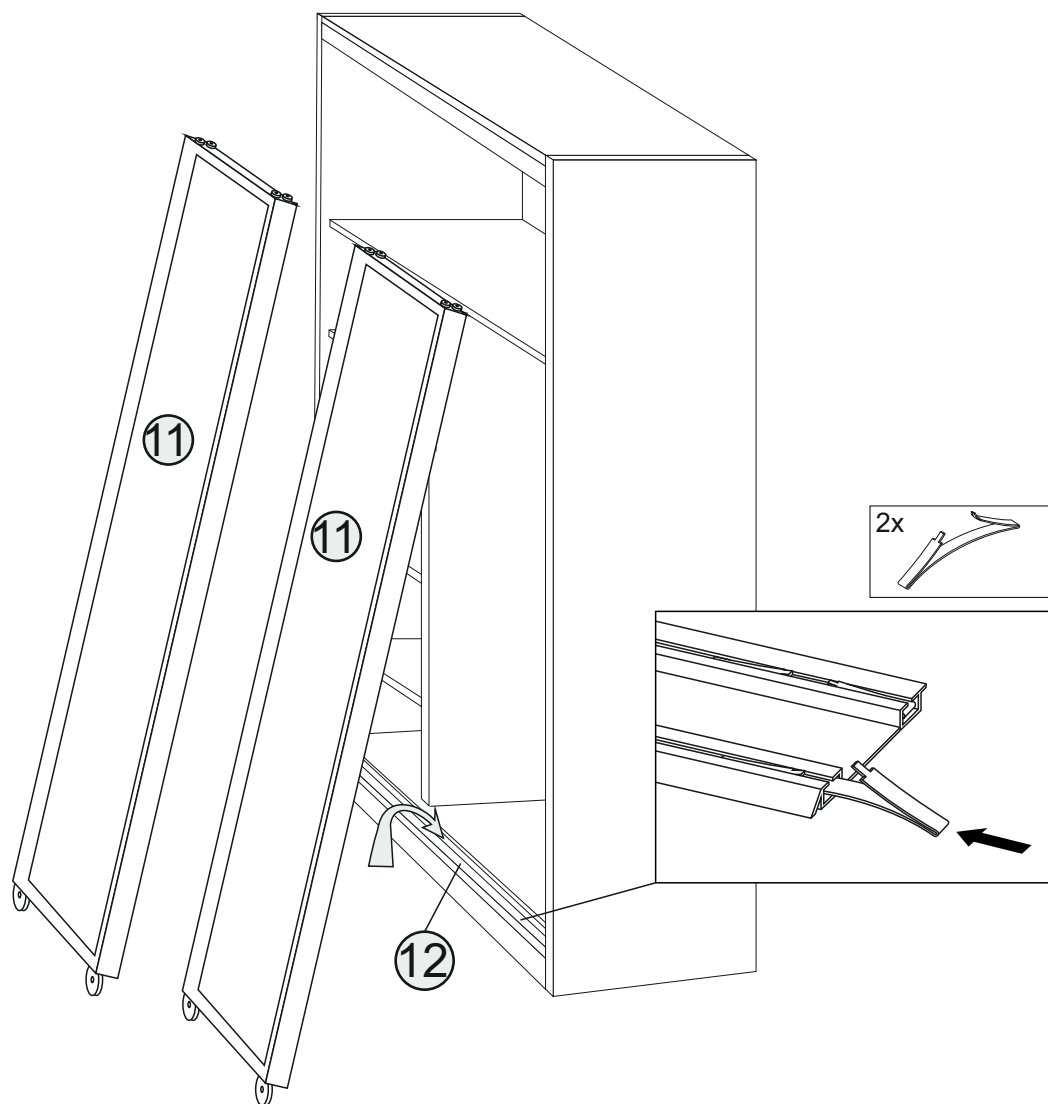



# 10

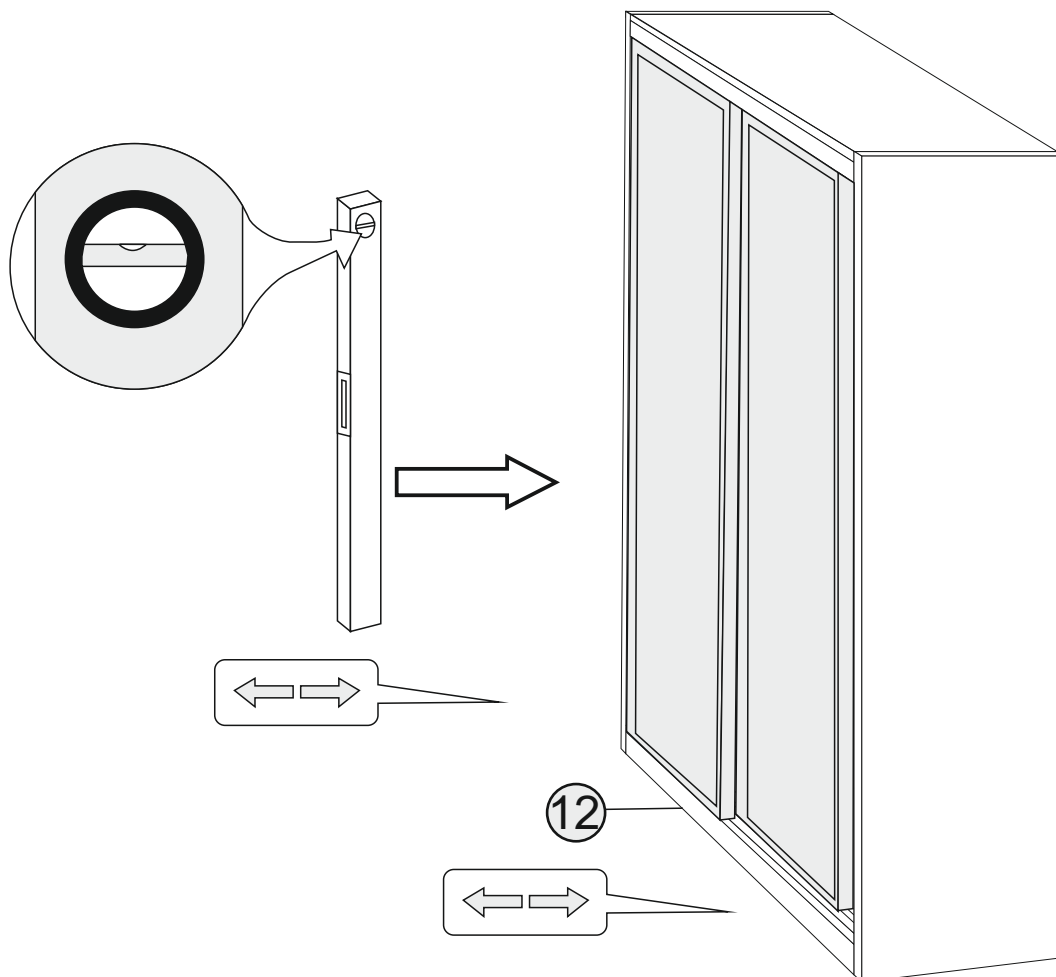

# 11

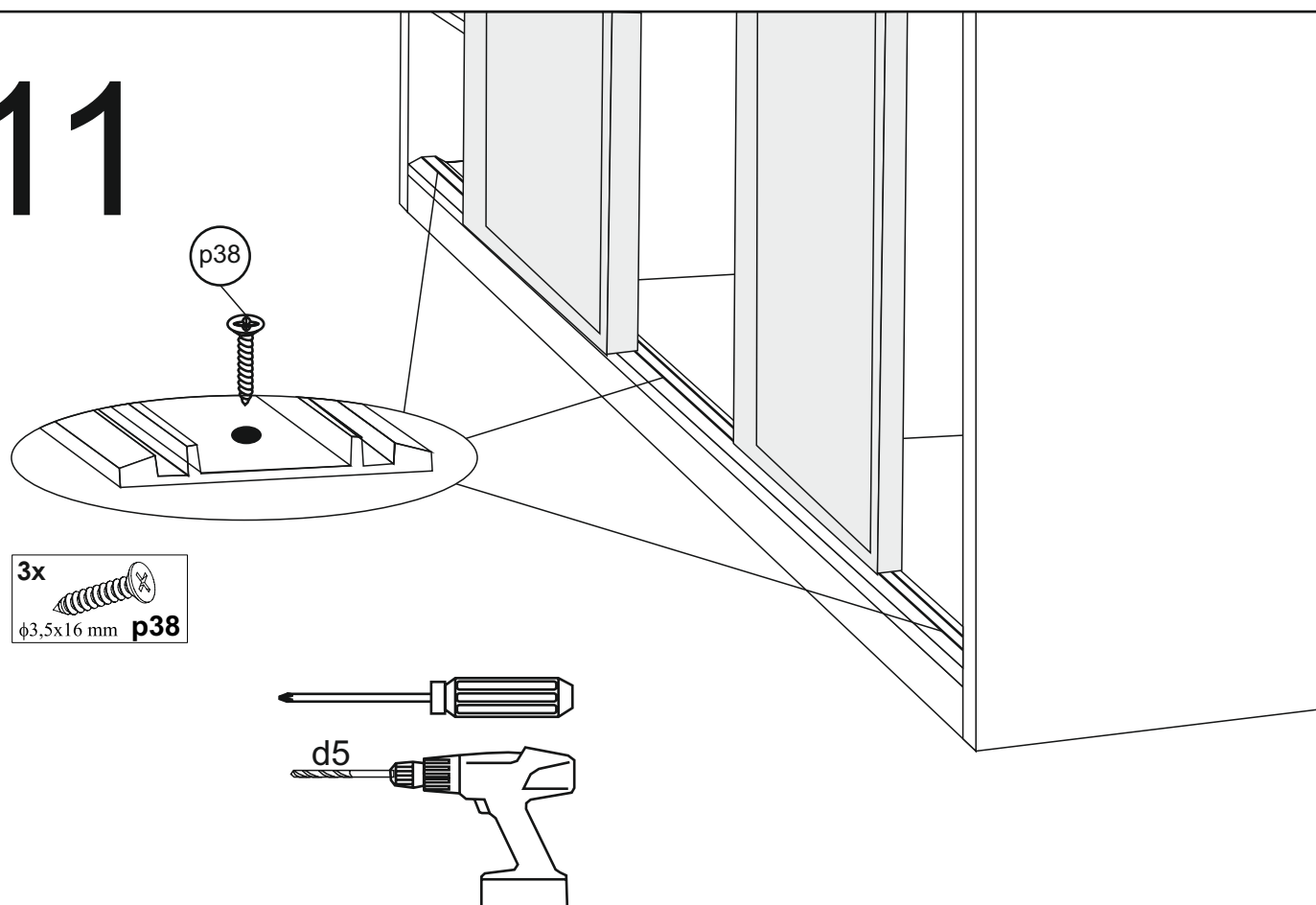

# 12

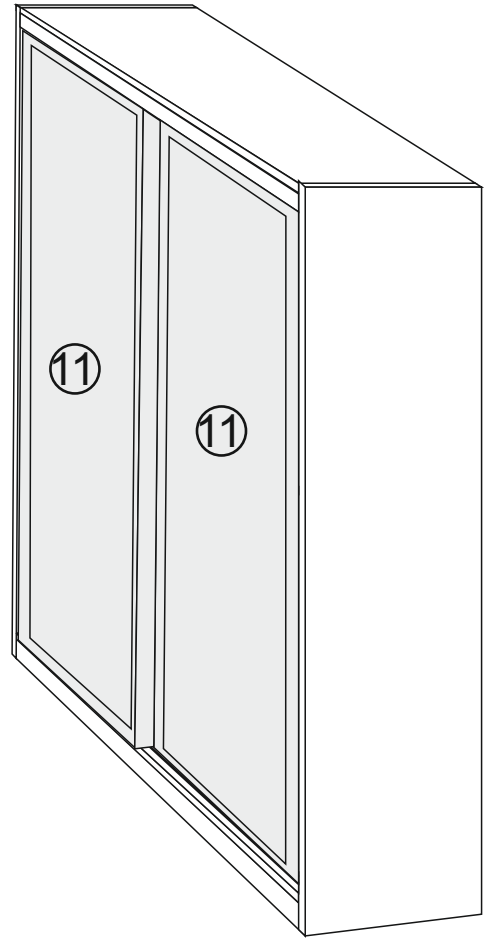
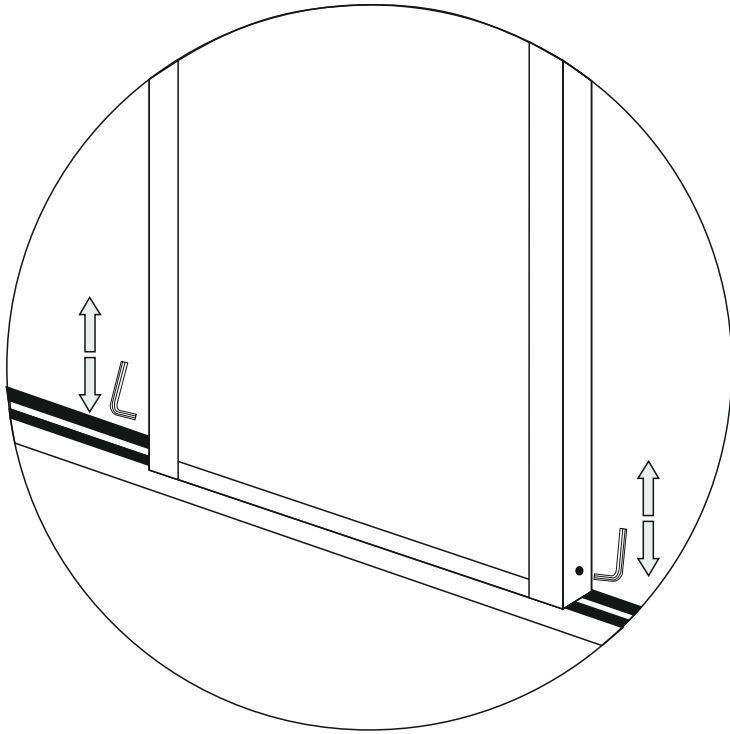

# 13

