



Surub maner m4*40=2 buc



Cep lemn 8*35 mm = 80 buc



Surub cap inecat 3,5*30=20 buc



Surub cap inecat 3,5*16=30 buc



Eurosurub 7*50 mm =22 buc



Picior alunecator =10buc



Tija dubla demontabil =6 buc



Cama demontabil excentric=27 buc



Tija autofileteta demontabil =15 buc



Maner metalic =1 buc



Rotila sertar=4 buc



Holzsurub 2,5*20 sau cui pentru PFL=20 buc

Schita montaj pat Beta 140



Piese cadru pat :

Suport:1984*250*2buc

LatS 2000*160*2buc

LatJ 1984*160*2buc

Fsus 1433*160*1buc

Fjos 250*366*2 buc

Piese sertar :

Fata 750 *160*1buc

Latsert520*120*2buc

Lonjsert600*120*2buc

Pfl 625*515*1buc

Suport saltea -

1400*320*4 buc

Piese tableie pat

T1S 1432*160*1buc

T2S 1112*160 *1 buc

T3J 1112*520 *1 buc

T4L 740*160 *2 buc

T5OLat900*70 *2 buc

T6OSus 1466*70*1 buc

spate

CB Furniture Bacau Romania

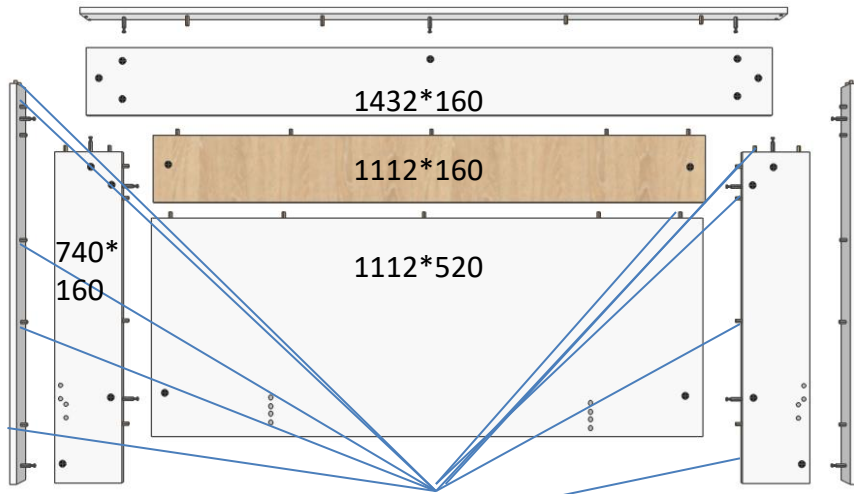

Cep lemn 8*35

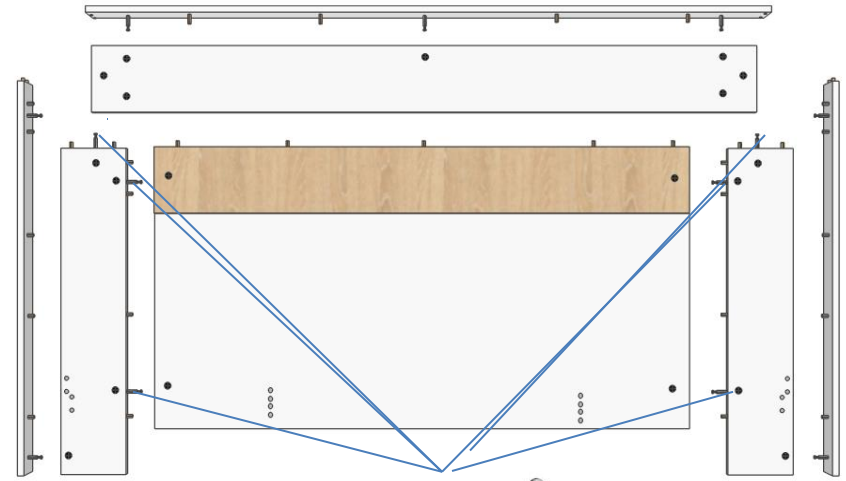

Tija dubla

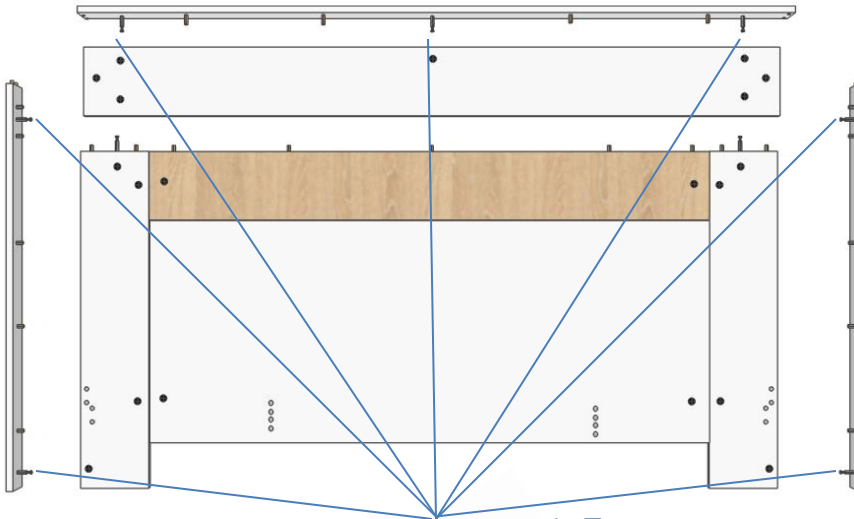

Tija demontabil

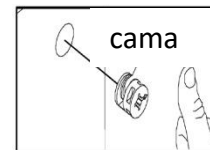
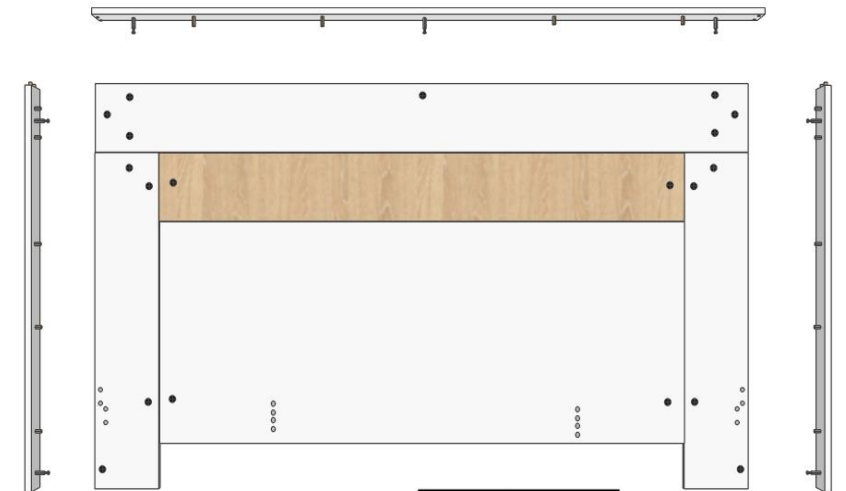

Fabricat in Romania

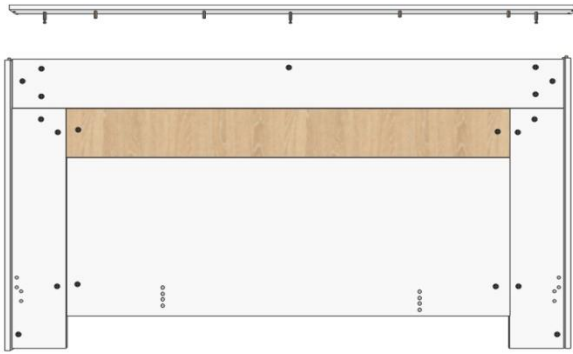

Se monteaza tije autofiletate si
cepurile pe placa

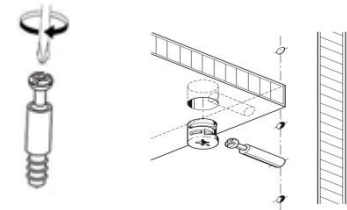
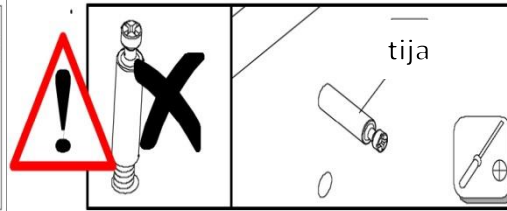
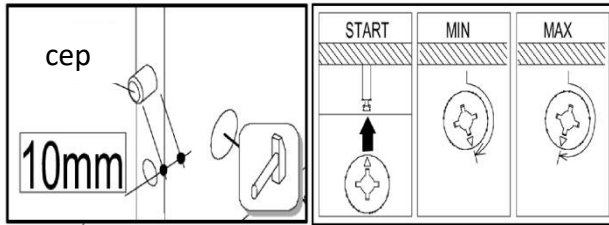
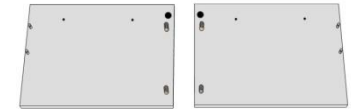

Cepurile din lemn ce depasesc 10 mm trebuie ajustate

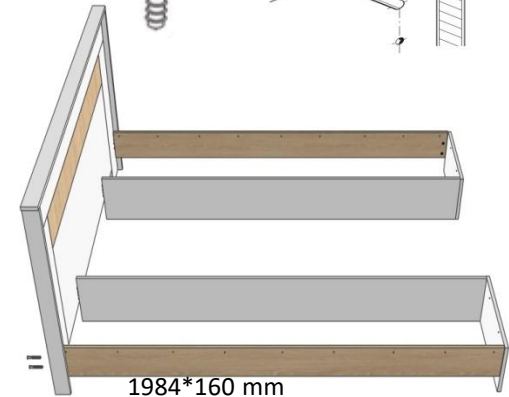

se infileteaza eurosuruburile 7*50

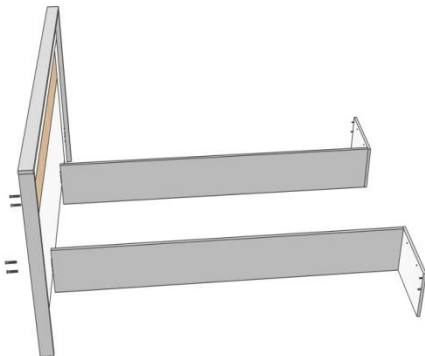

se infileteaza eurosuruburile 7*50

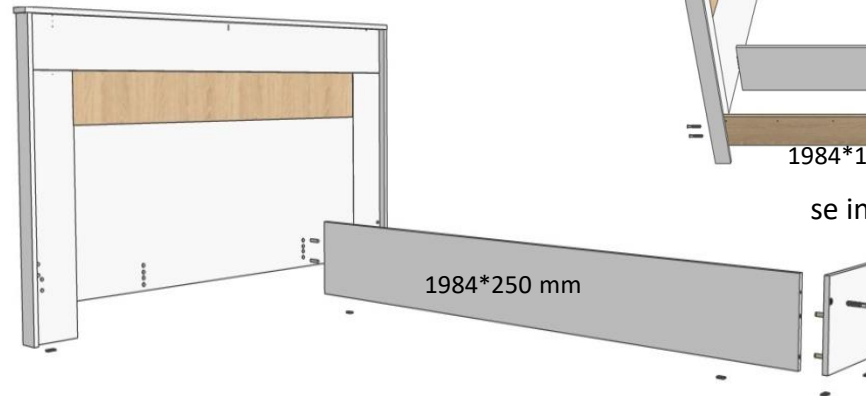

Se fixeaza picioarele cu 2 buc 3,5*16

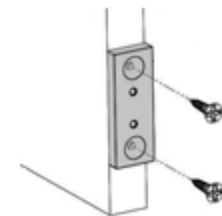

Se fixeaza cama in gauri



se infileteaza eurosuruburile 7*50



se fixeaza definitiv cu 3,5*30

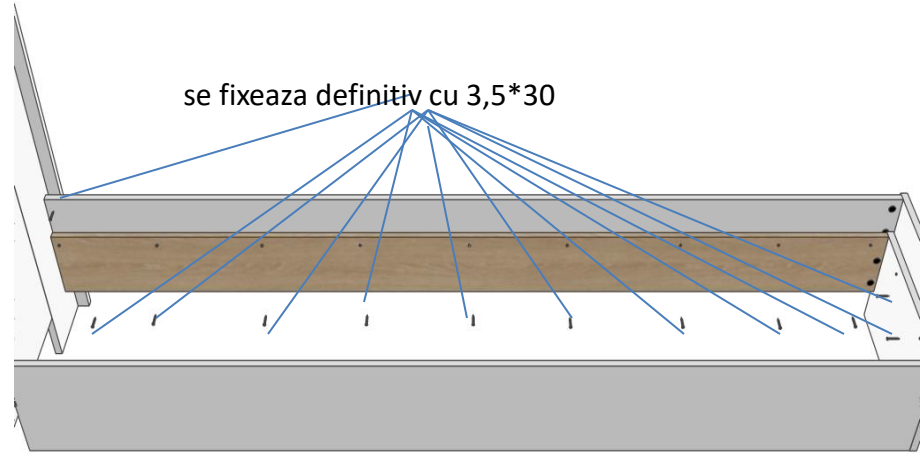

se fixeaza tablia mica cu cama excentrica

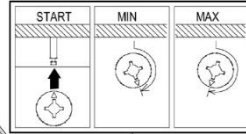

2000*160 mm

Suportul de saltea se fixeaza definitiv cu 3,5*30 cu distante egale intre ele



Se fixeaza rotilele cu 3,5*16mm pe marginea sertarului ,apoi se fixeaza cele 2 cepuri de ghidaj pe lateralele sertarului, se fixeaza fata de sertar , apoi se prinde manerul cu suruburile m4*40

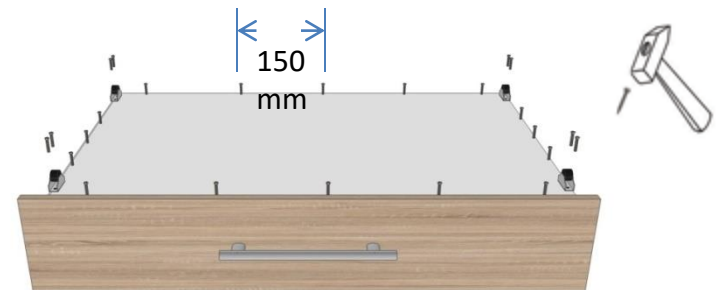

se infileteaza eurosuruburile 7*50 si prinde HDF ul cu 2,5*20 sau cuie , cu diagonalele sertarului egale

