

Sliding wardrobe City Lite 2250x1500x600 mm

ASSEMBLY INSTRUCTION

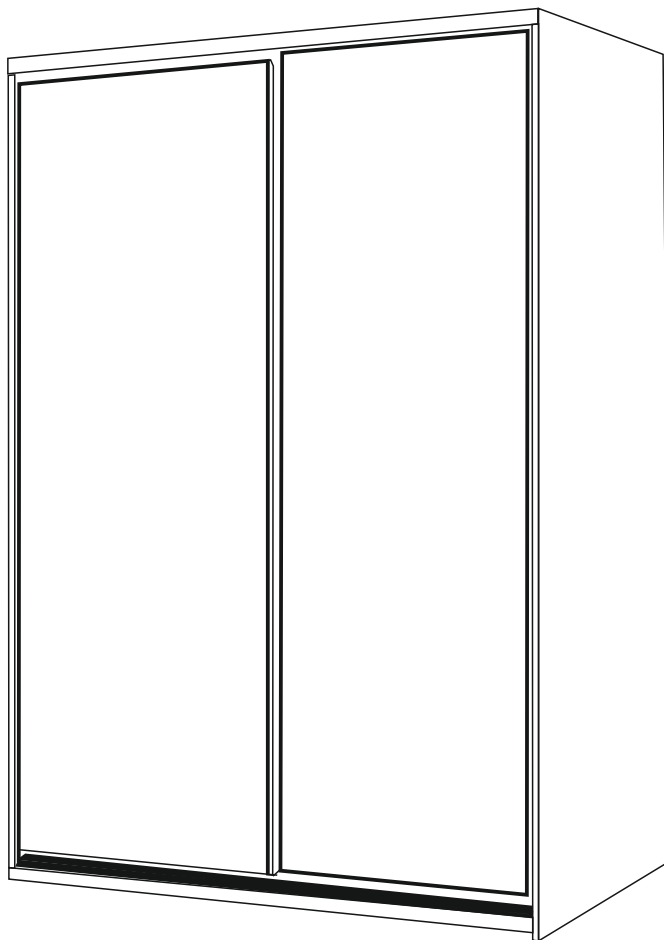

Dimensions
Height: 2250 mm
Width: 1500 mm
Depth: 600 mm



NOTE!

For all questions and complaints about this product, please contact the place of purchase of this product.



RULES FOR USE AND CARE OF FURNITURE

1. Use furniture only in dry rooms protected from the effects of weather conditions.
2. Install with suitable tools according to these assembly instructions.
3. Try to assemble as close to the location as possible.
4. The body is assembling in a horizontal position.
5. Before moving furniture, make sure that it is not loaded with items.

Caution: moving furniture may damage it.

When moving, hold on to vertical elements only; moving furniture by horizontal parts can break the product.

6. Overloading the furniture can damage it.
7. From time to time check the fittings and their correct position.
8. Wipe the furniture surface only with a slightly damp cloth or paper towels. Do not use chemical cleaning agents other than those specifically made for this.

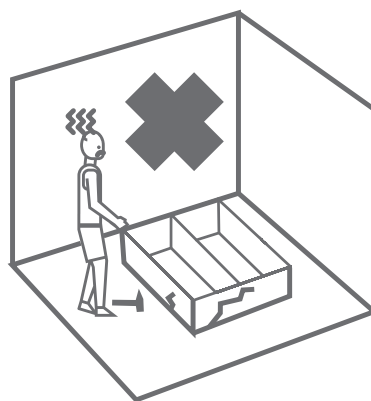
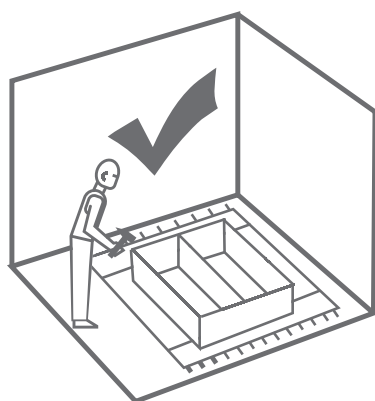
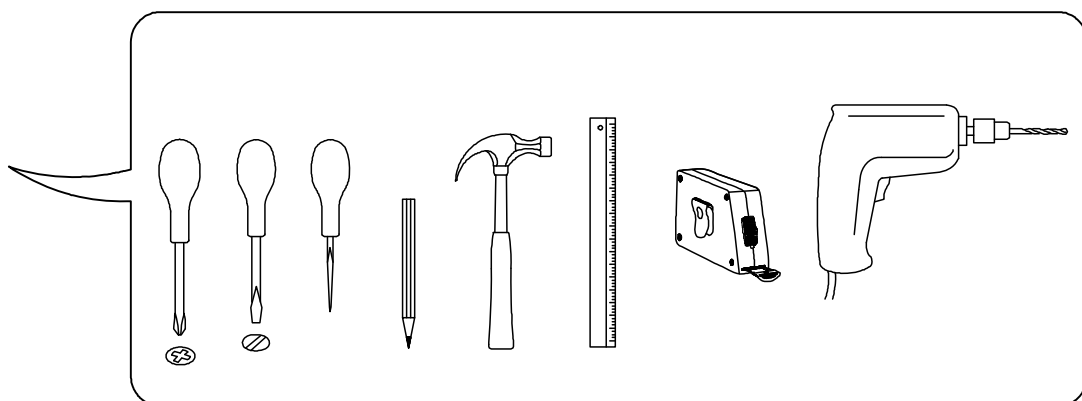

60-120 min

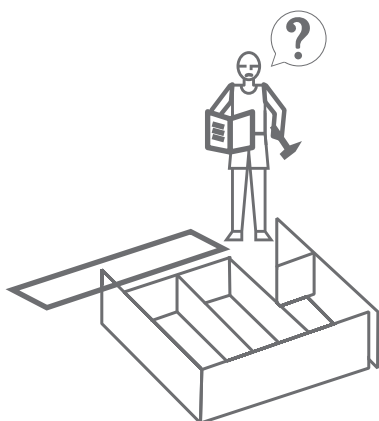
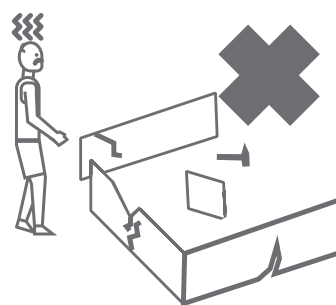
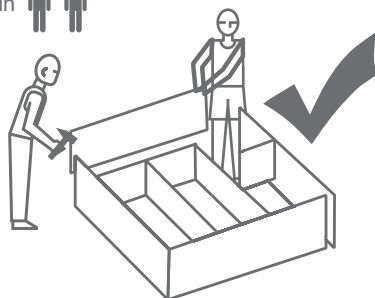

PARTS LIST

Nº	Description	Dimensions		Nº pack	Qty.
01	Side stand left	2250	598	1/3	1
02	Side stand right	2250	598	1/3	1
03	Inner stand	1772	495	1/3	1
04	Back wall (fiberboard)	2200	498	1/3	3
05	Roof	1468	598	2/3	1
06	Bottom	1468	598	2/3	1
07	Transverse shelf	1468	500	2/3	1
08	Shelf	448	473	2/3	4
09	Bottom located along	1468	46	2/3	2

Nº	Description	Dimensions		Nº pack	Qty.
10	Guide profile top	1468		2/3	2
11	Wardrobe door			3/3	2
12	Guide profile bottom	1468		2/3	1
13	Wardrobe rod	998	25	2/3	1
14	Bottom located across	520	46	2/3	1

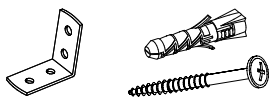
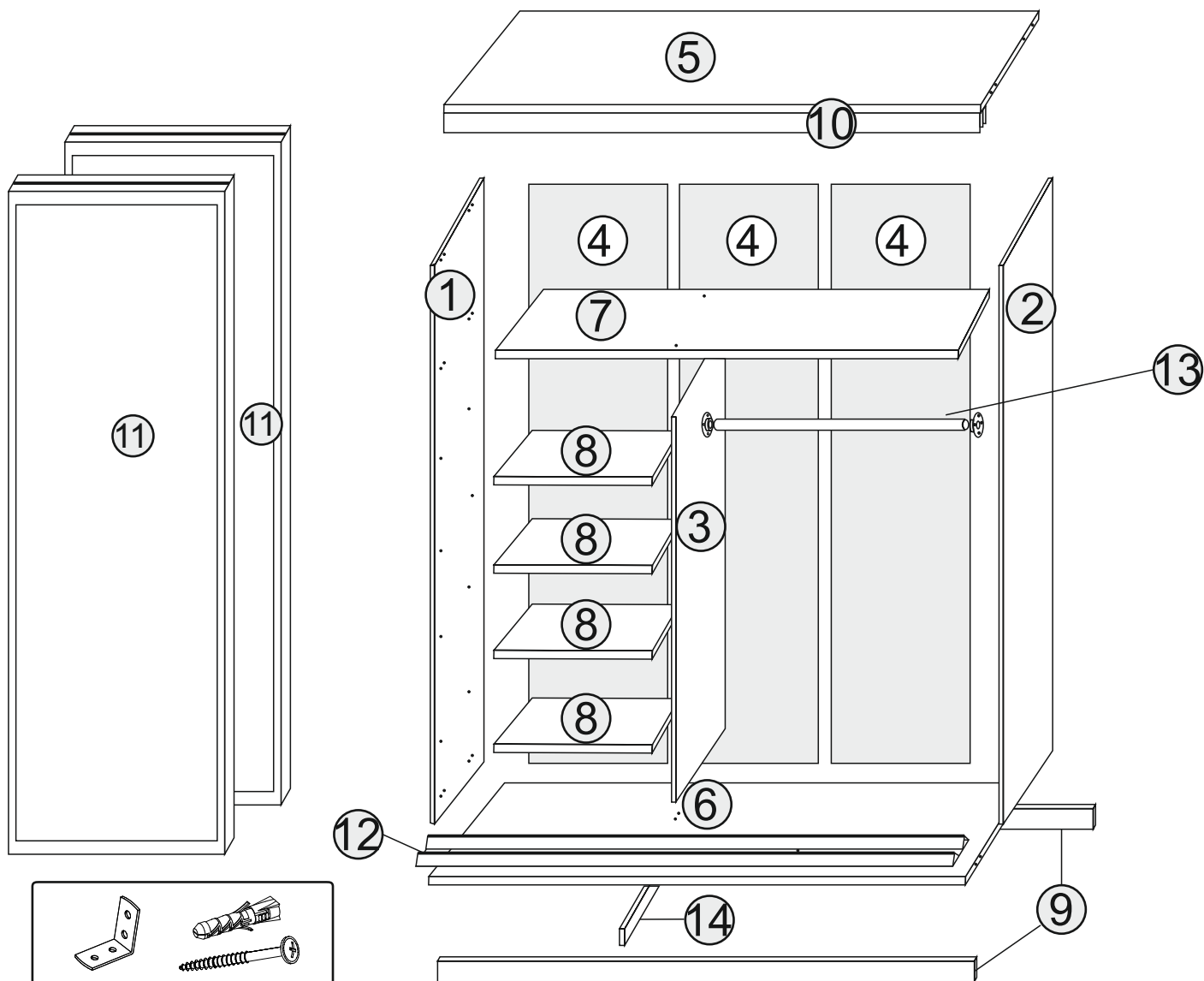

The dowel and the wall mounting angle are not included. Purchase separately.

Fittings:

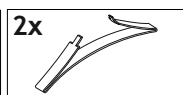
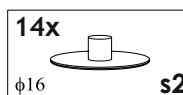
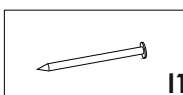
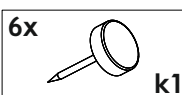
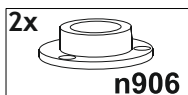
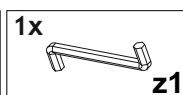
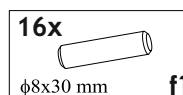
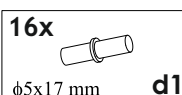
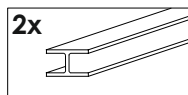

1

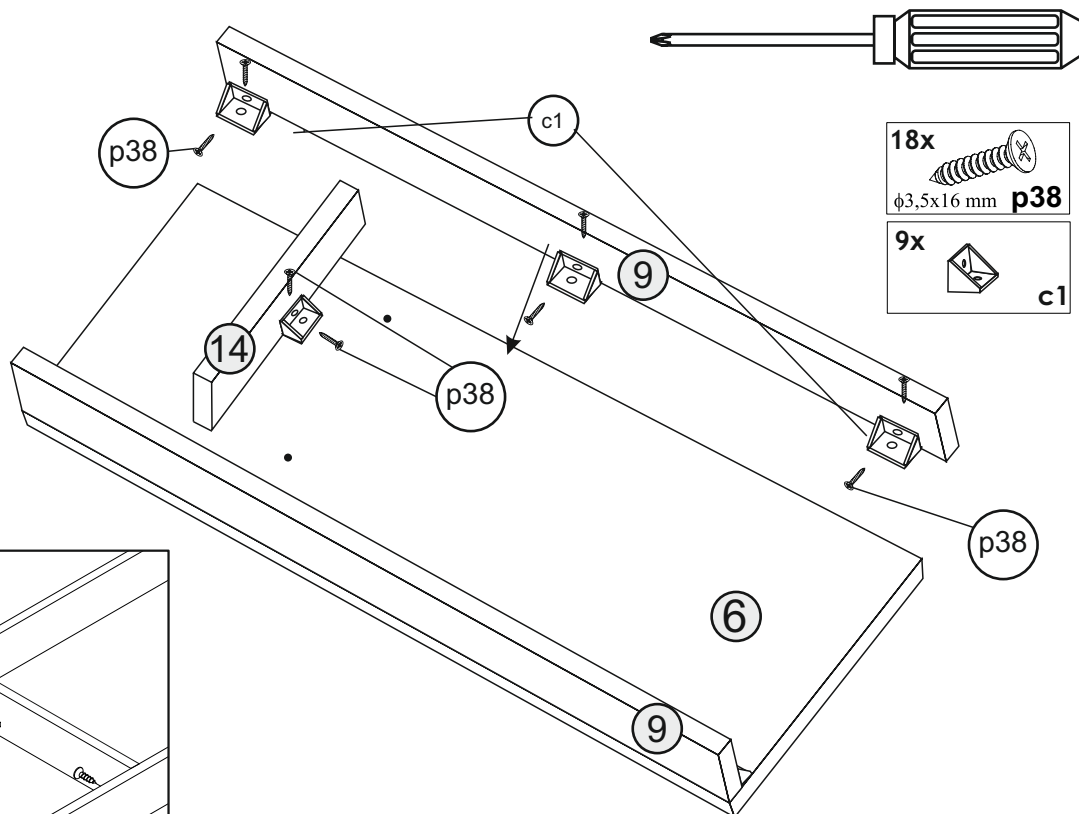

2

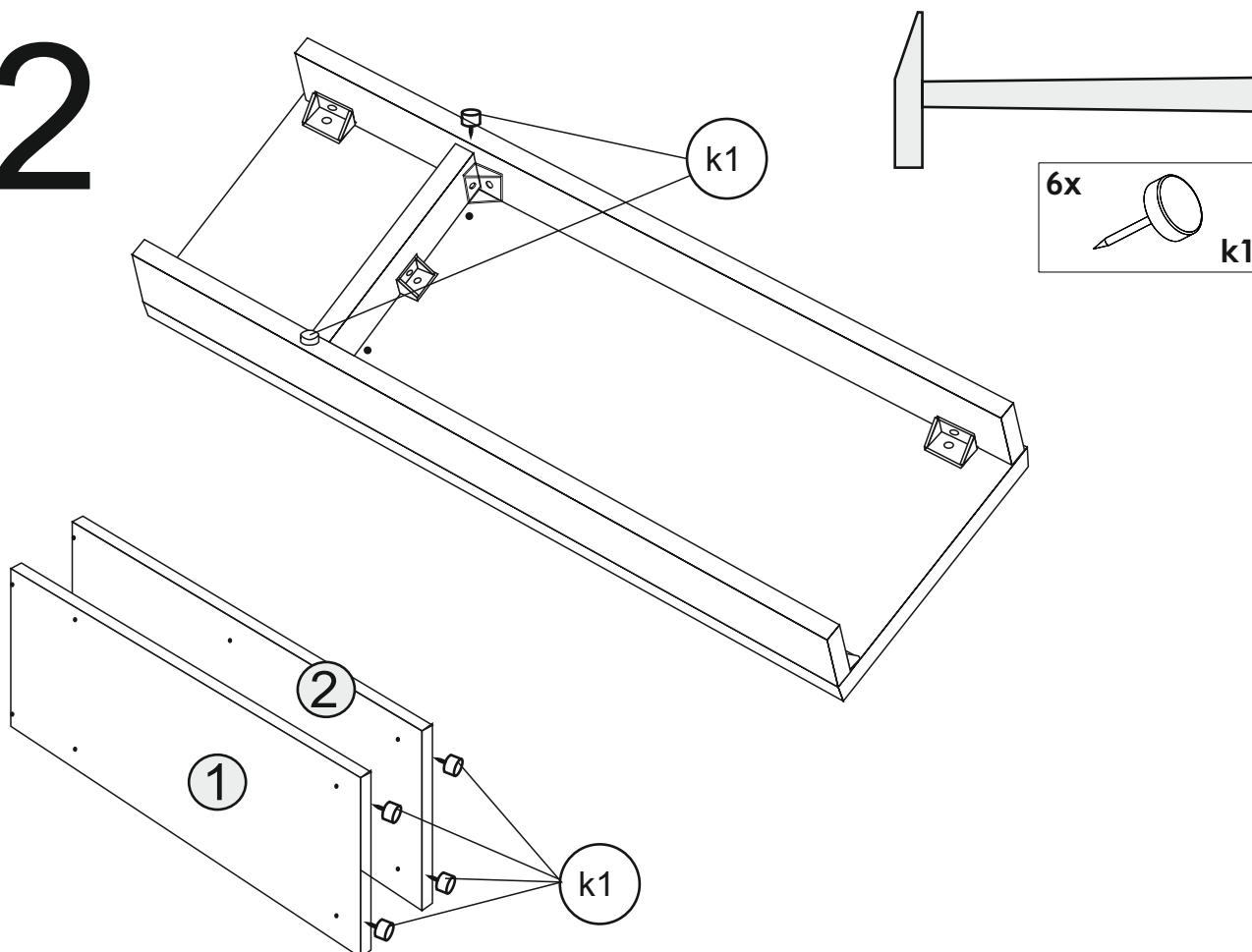

3

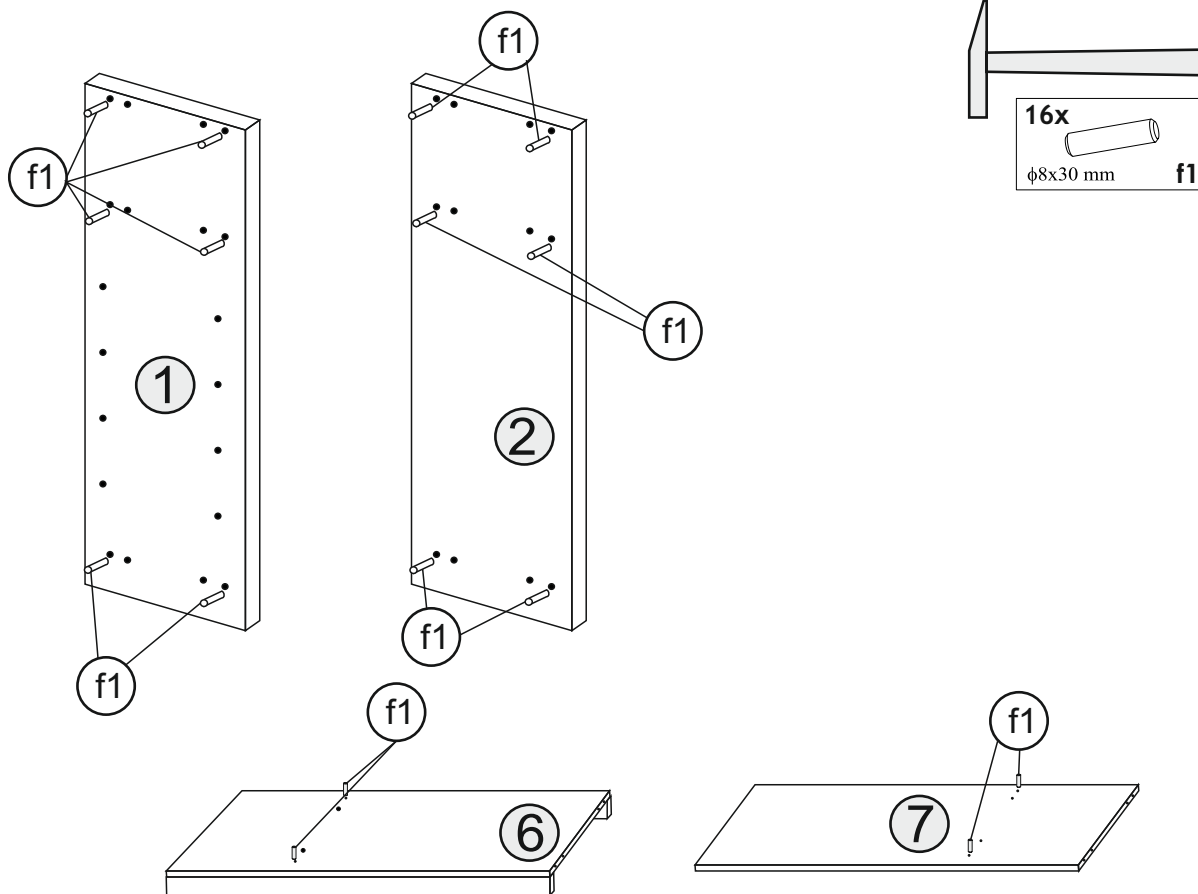

4

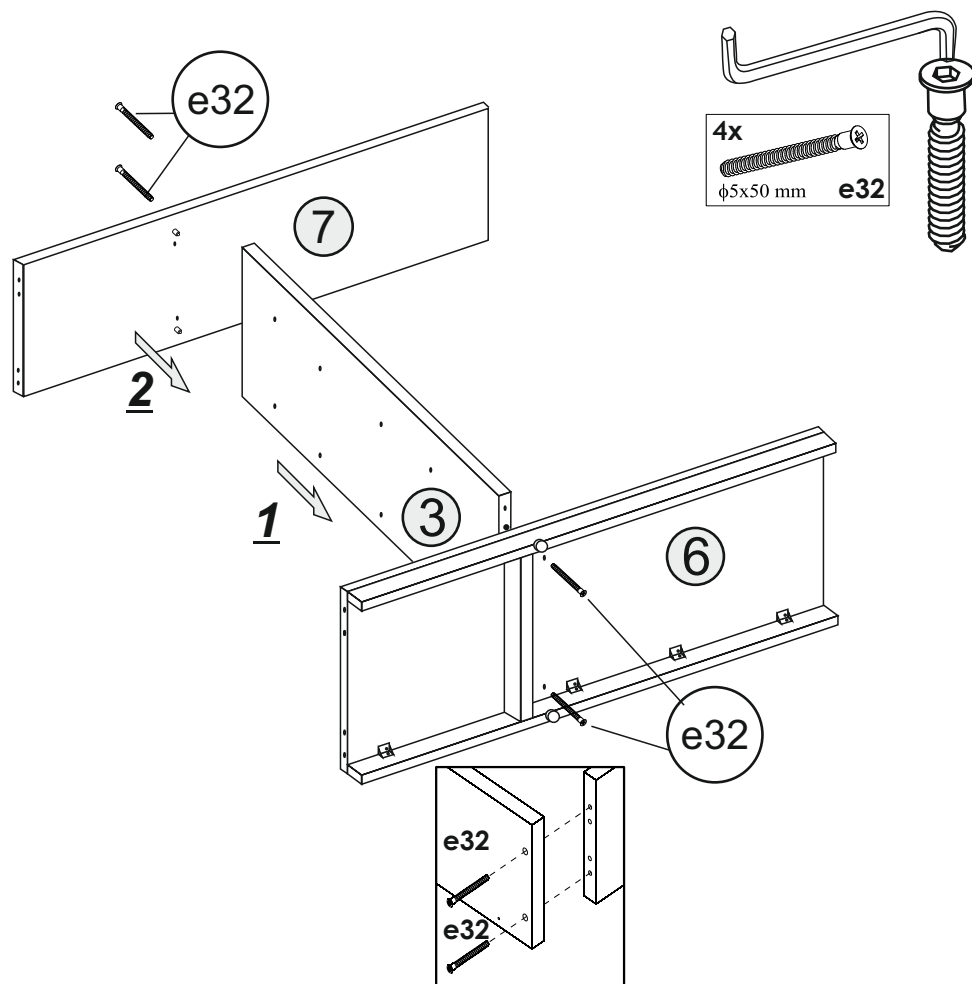

5

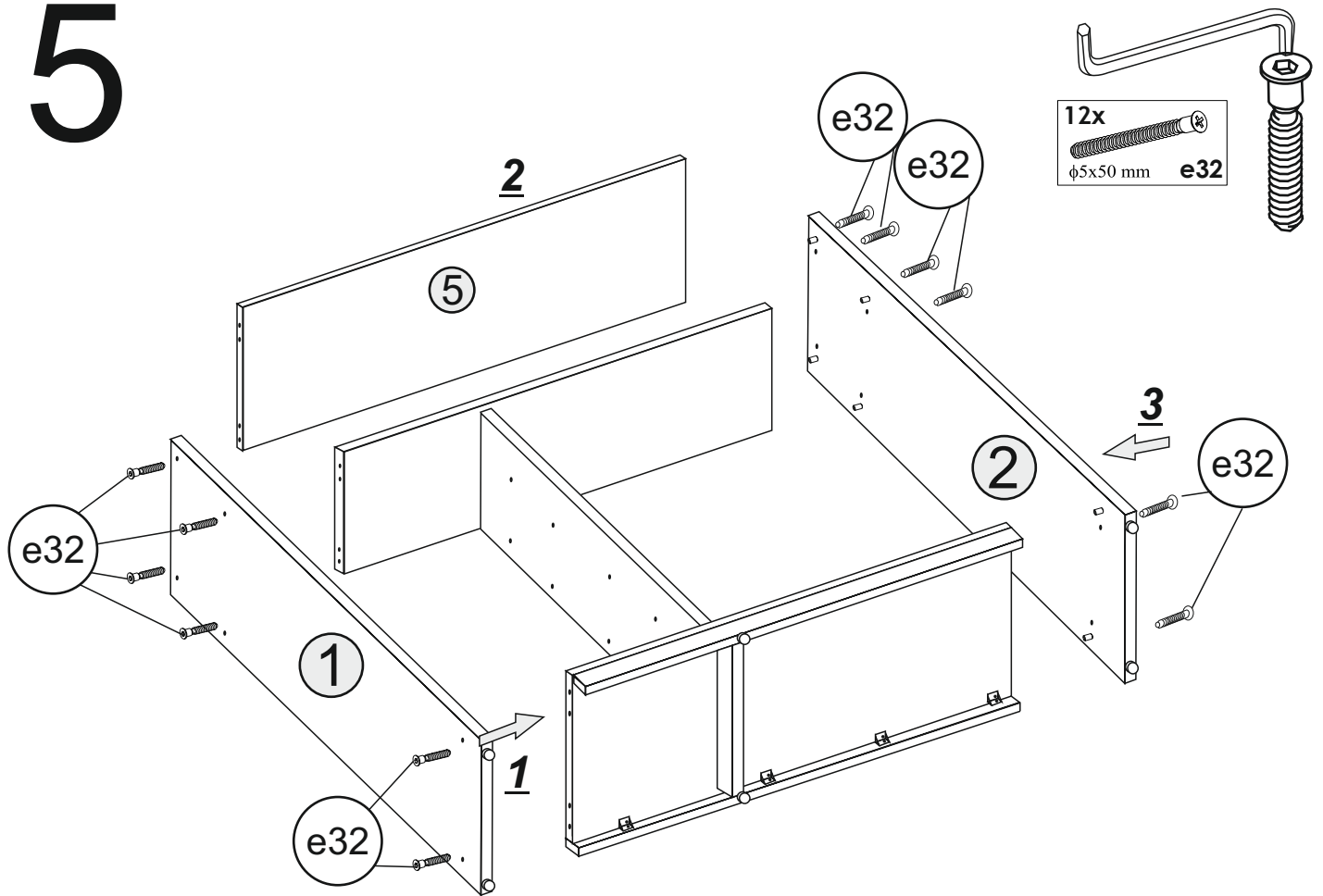

6

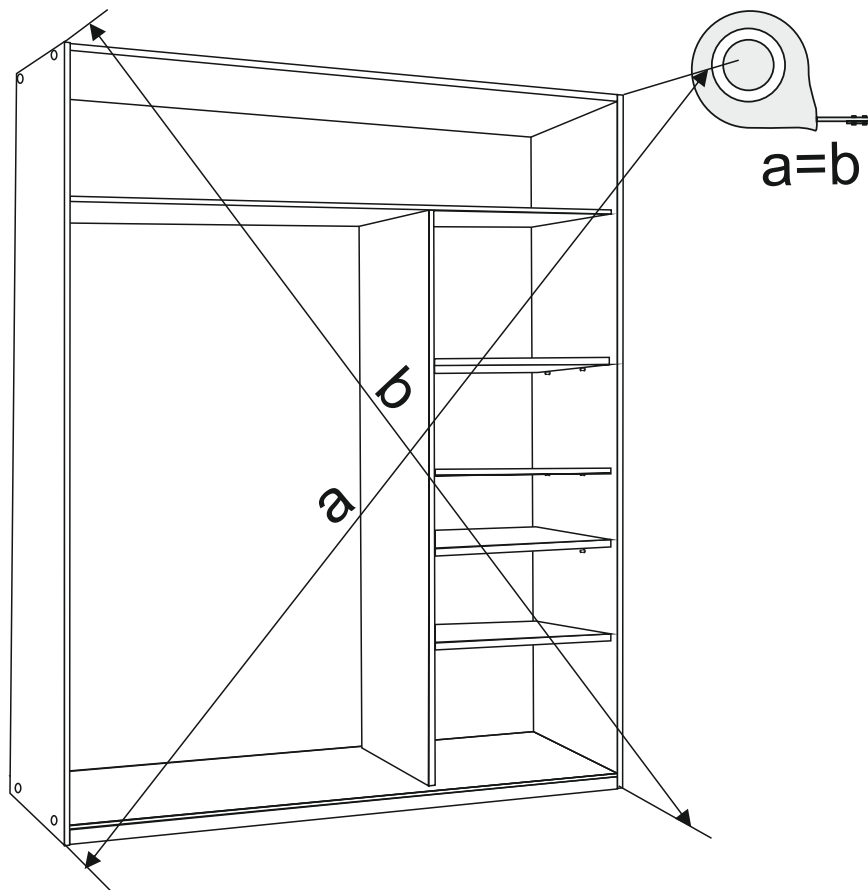

7

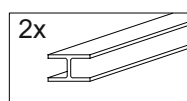
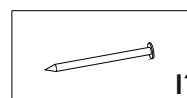
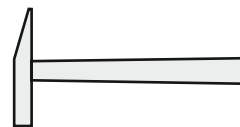
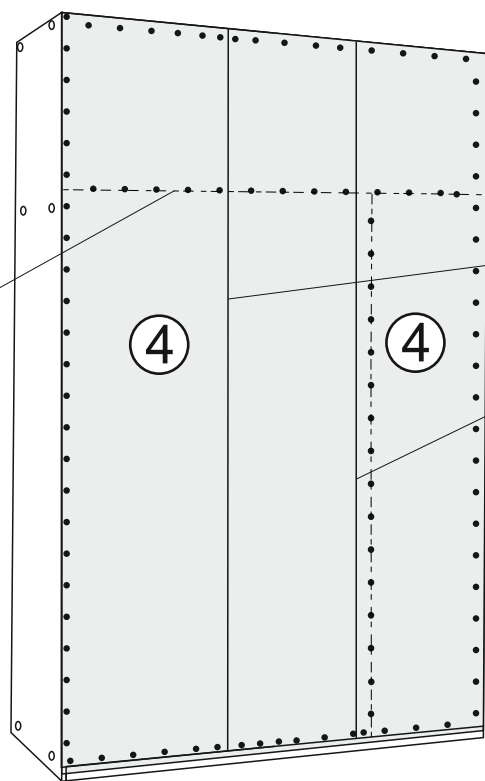
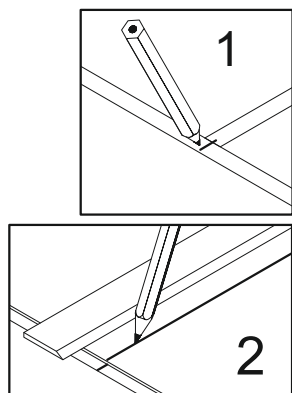

8

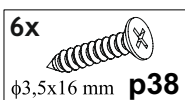
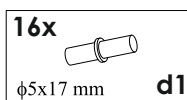

10

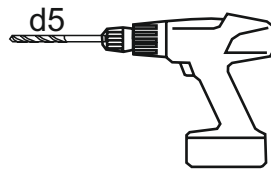
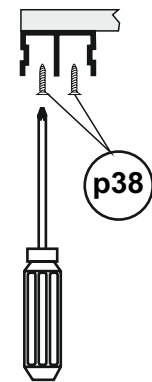
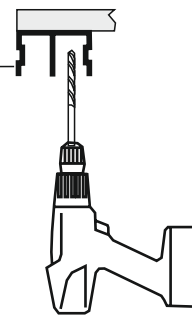
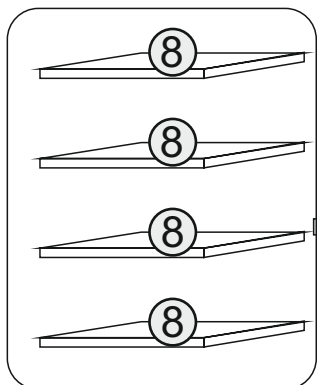
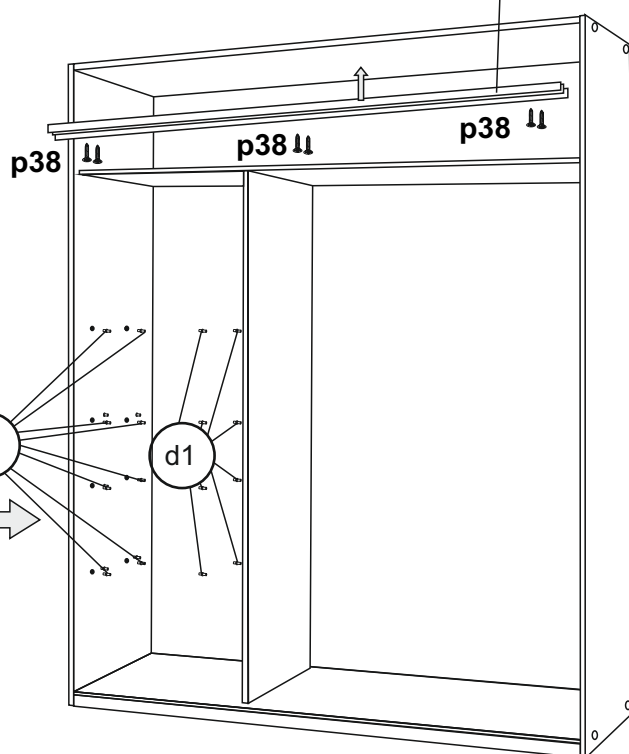

9

6x
 $\phi 3,5 \times 16 \text{ mm}$ p38

2x
 n906

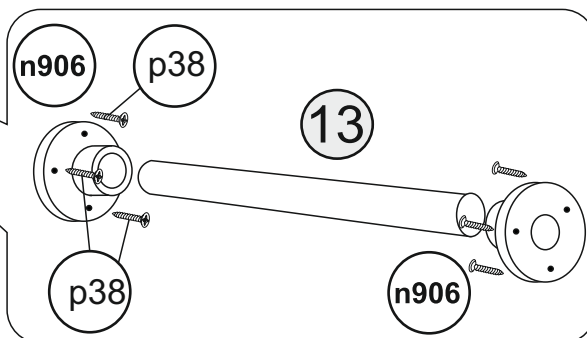
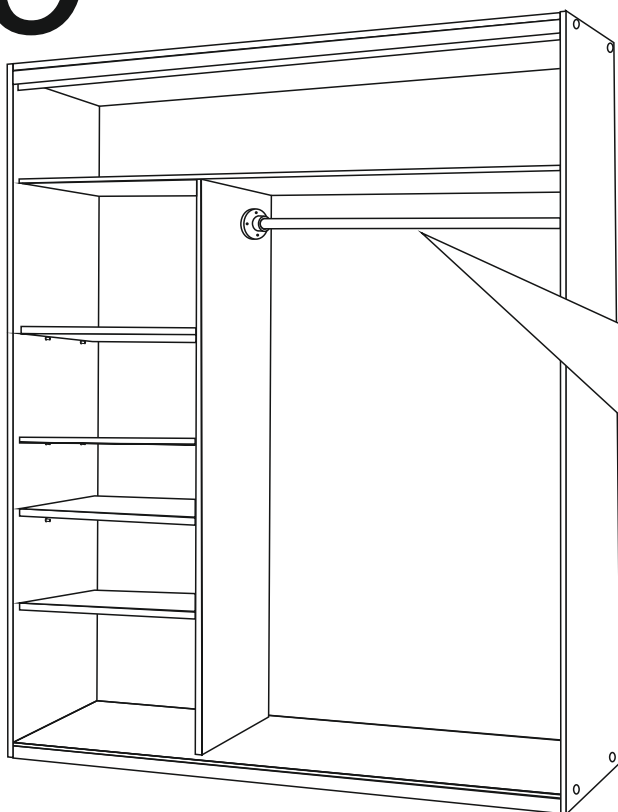
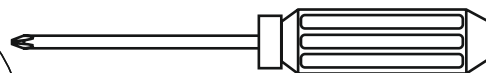
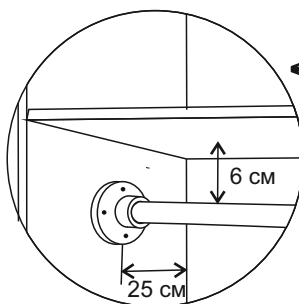

10



2x

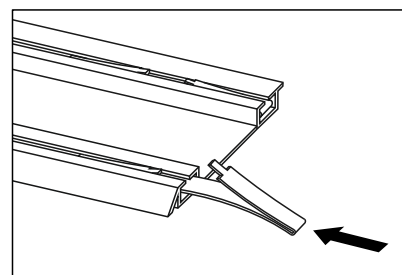

12

11

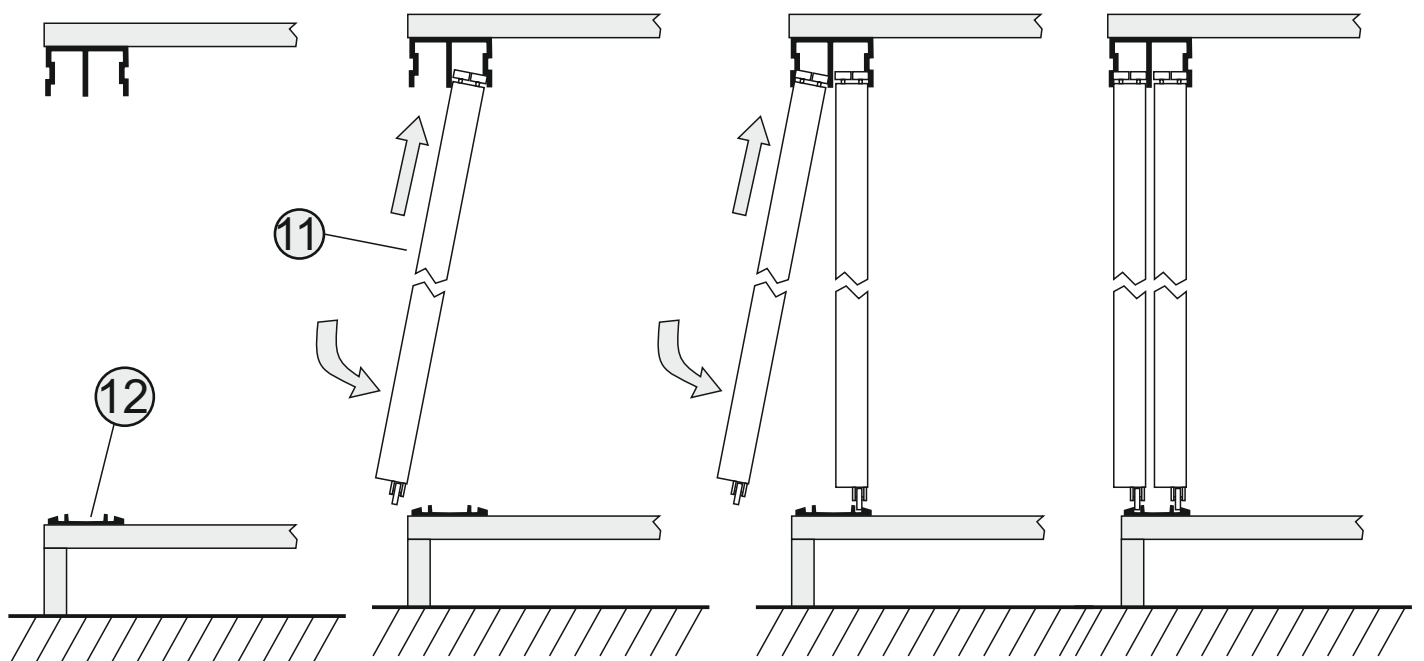
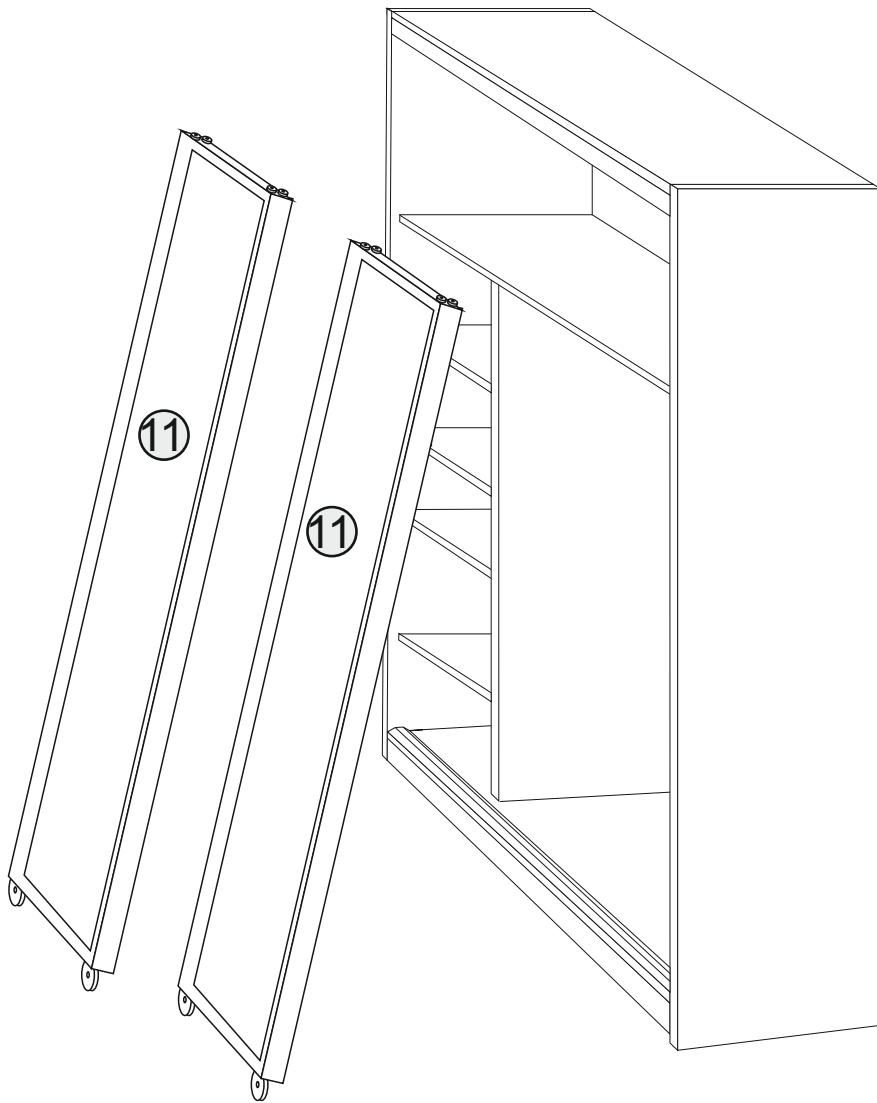

12

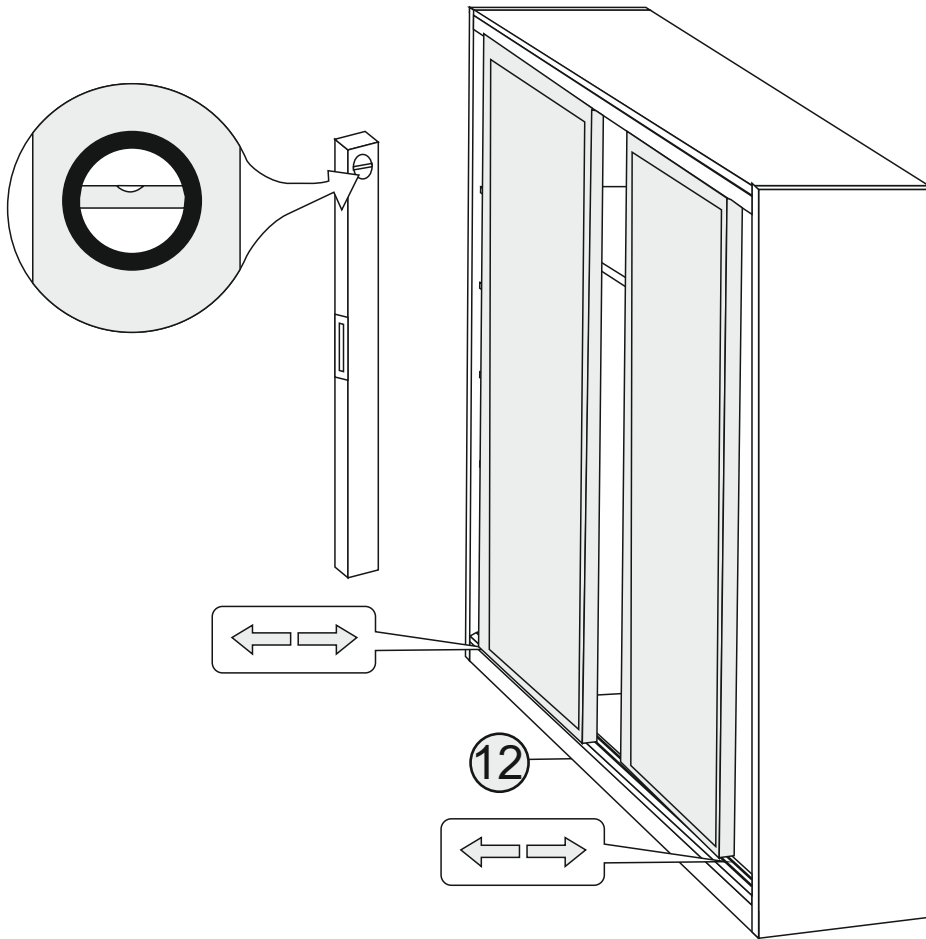

13

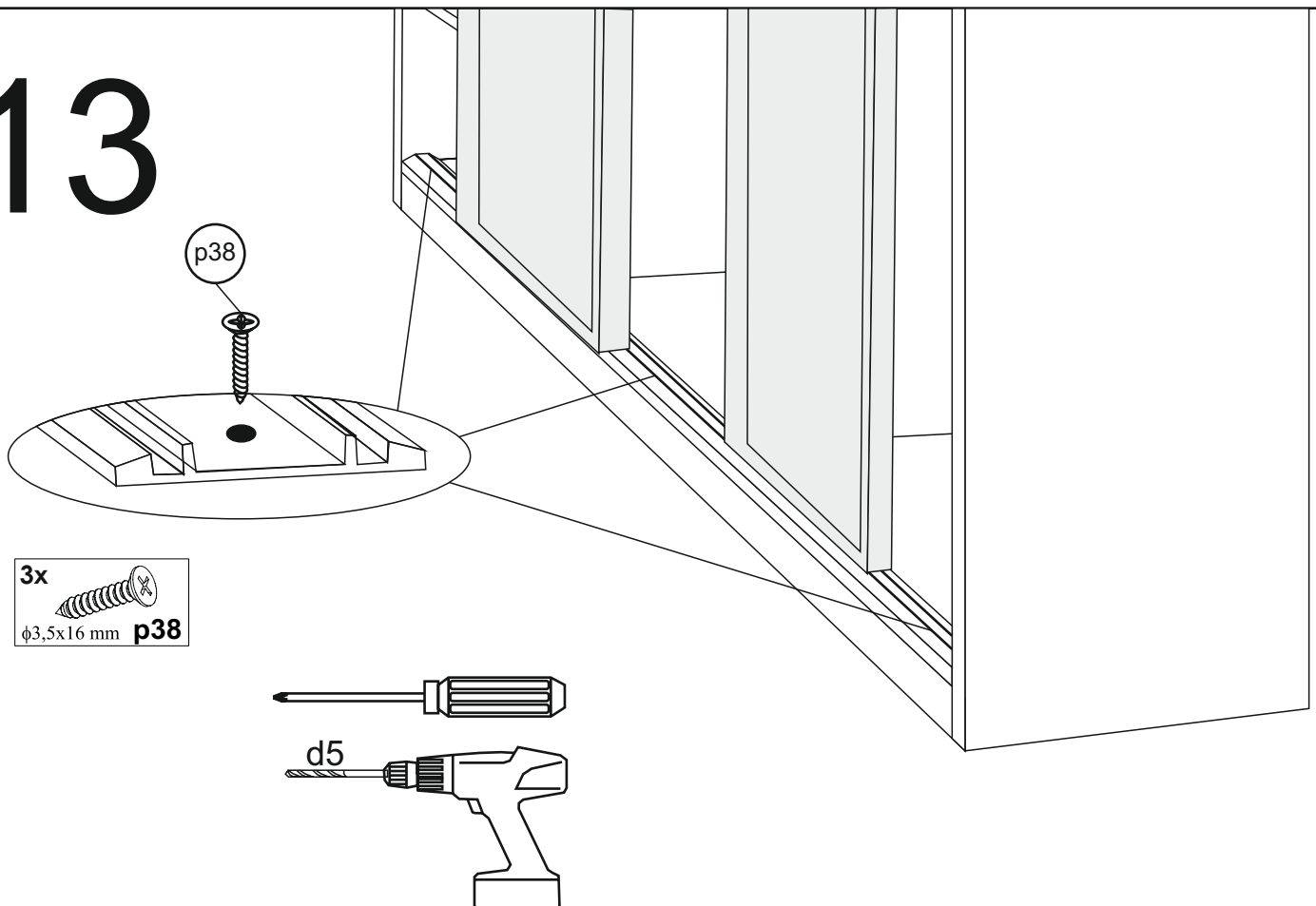

14

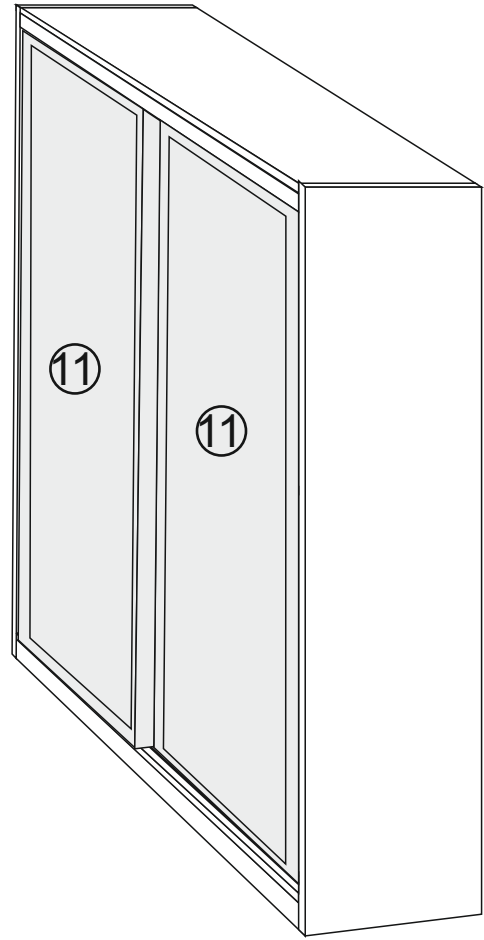
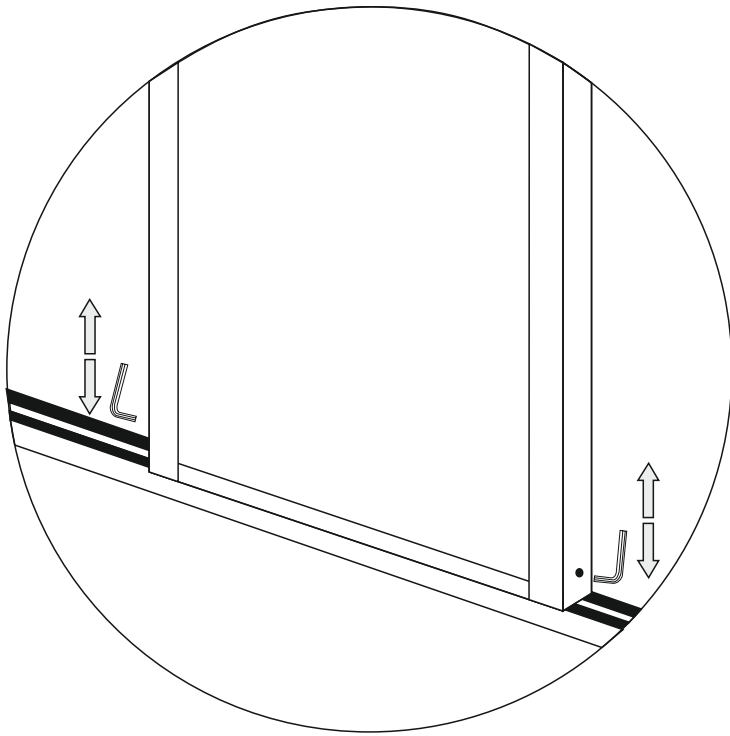

15

