

# Table side extension 664x430x420 mm

## ASSEMBLY INSTRUCTION



### To avoid falling

fill the drawers gradually from bottom to top.

Dimensions  
Height: 664 mm  
Width: 430 mm  
Depth: 420 mm



### **NOTE!**

For all questions and complaints about this product, please contact the place of purchase of this product.



## **RULES FOR USE AND CARE OF FURNITURE**

1. Use furniture only in dry rooms protected from the effects of weather conditions.
2. Install with suitable tools according to these assembly instructions.
3. Try to assemble as close to the location as possible.
4. The body is assembling in a horizontal position.
5. Before moving furniture, make sure that it is not loaded with items.

**Caution:** moving furniture may damage it.

When moving, hold on to vertical elements only; moving furniture by horizontal parts can break the product.

6. Overloading the furniture can damage it.
7. From time to time check the fittings and their correct position.
8. Wipe the furniture surface only with a slightly damp cloth or paper towels. Do not use chemical cleaning agents other than those specifically made for this.

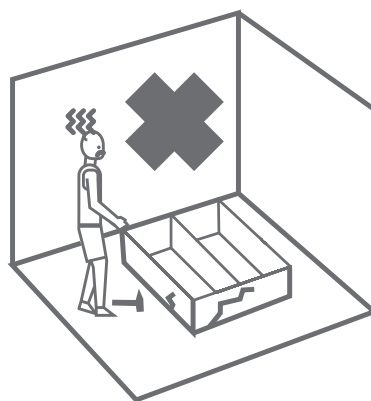
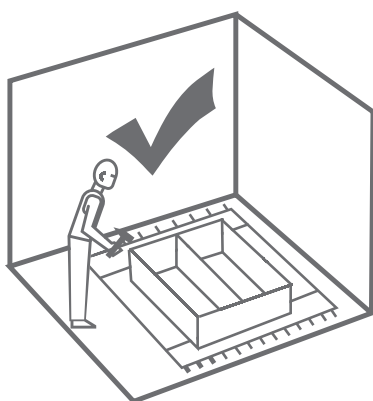
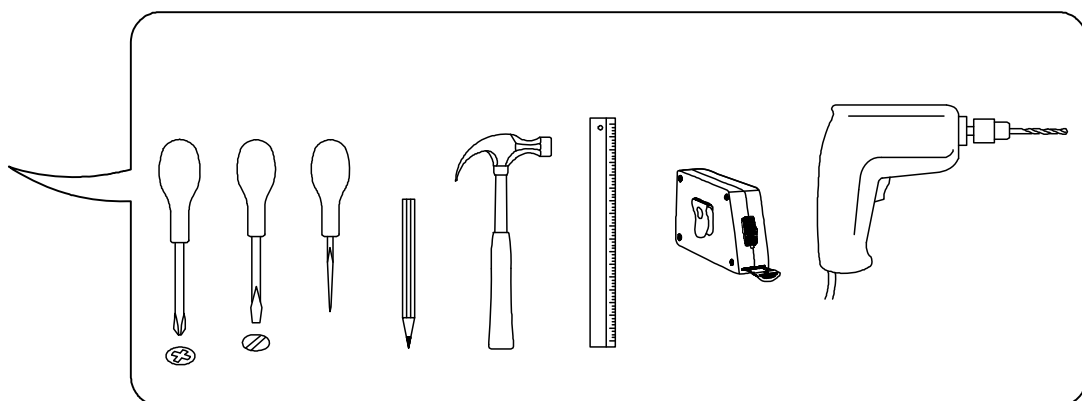

60-120 min

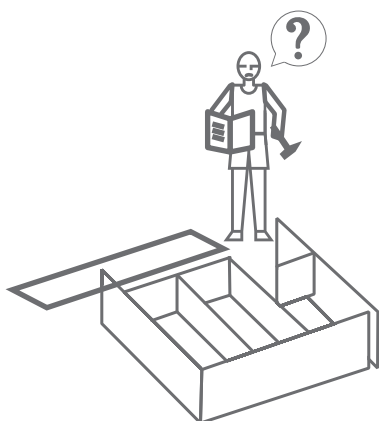
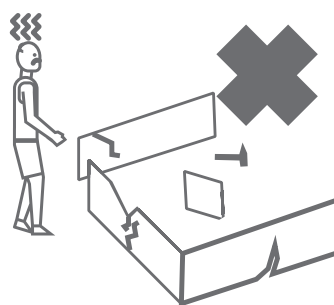
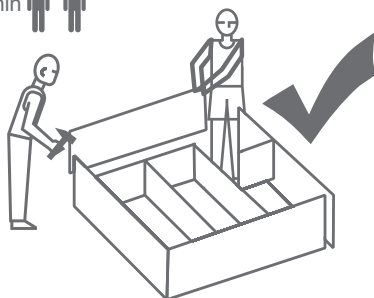

# PARTS LIST

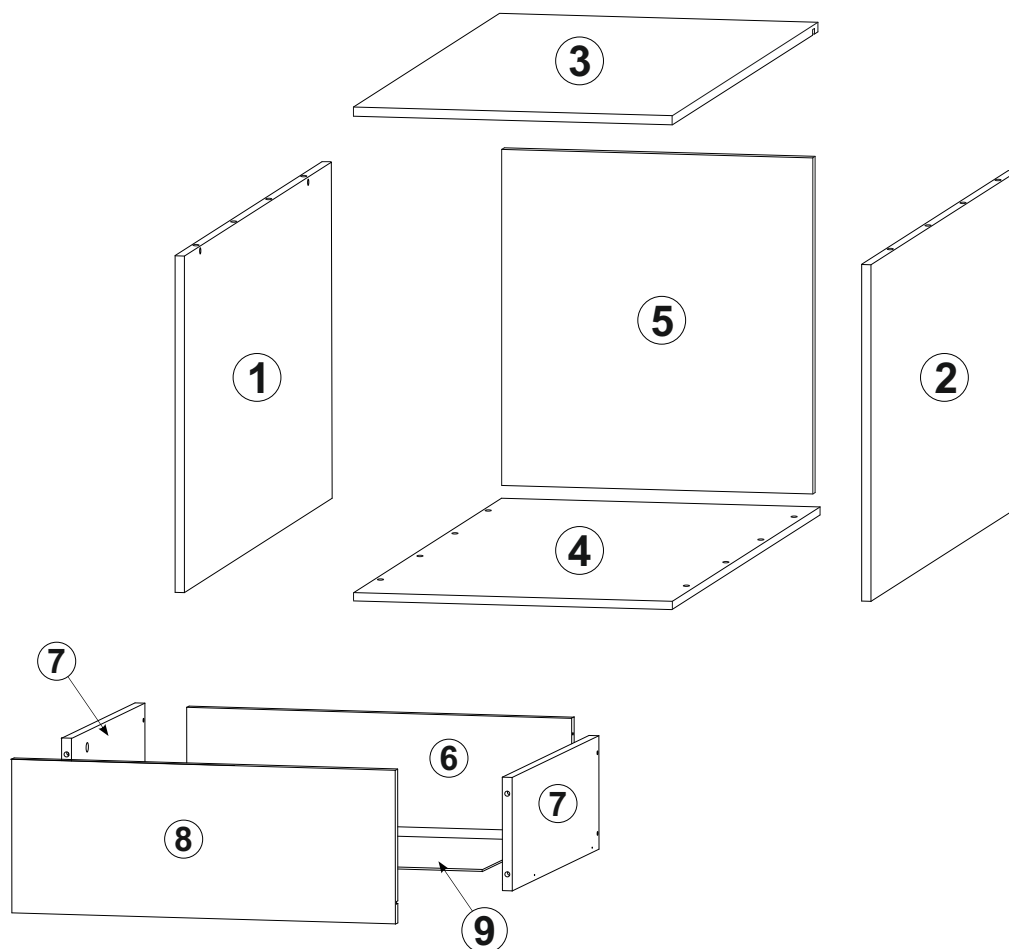

Nº	Description	Dimensions		Nº pack	Qty.
1	L.STAND	570	418	1	1
2	R.STAND	570	418	1	1
3	ROOF	430	420	1	1
4	BOTTOM	430	318	1	1
5	B.WALL	570	396	1	1

Nº	Description	Dimensions		Nº pack	Qty.
6	D.BACK	339	96.5	1	1
7	D.SIDE	350	96.5	1	1
8	D.FACADE	186	390	1	1
9	D.BOTTOM	354	369	1	1

## Fittings:

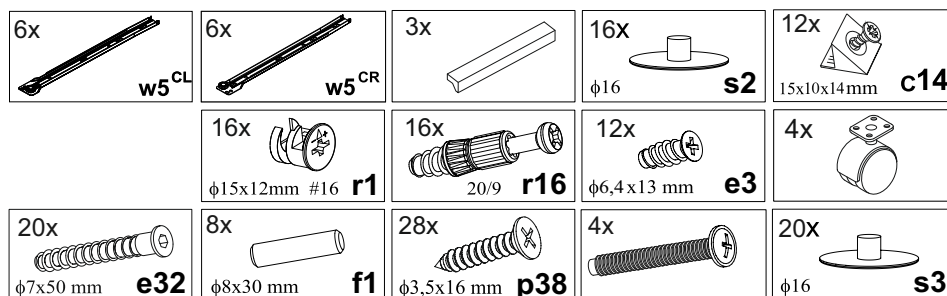

# 1

20x  
φ8x30 mm f1

16x  
20/9 r16

16x  
φ15x12mm #16 r1

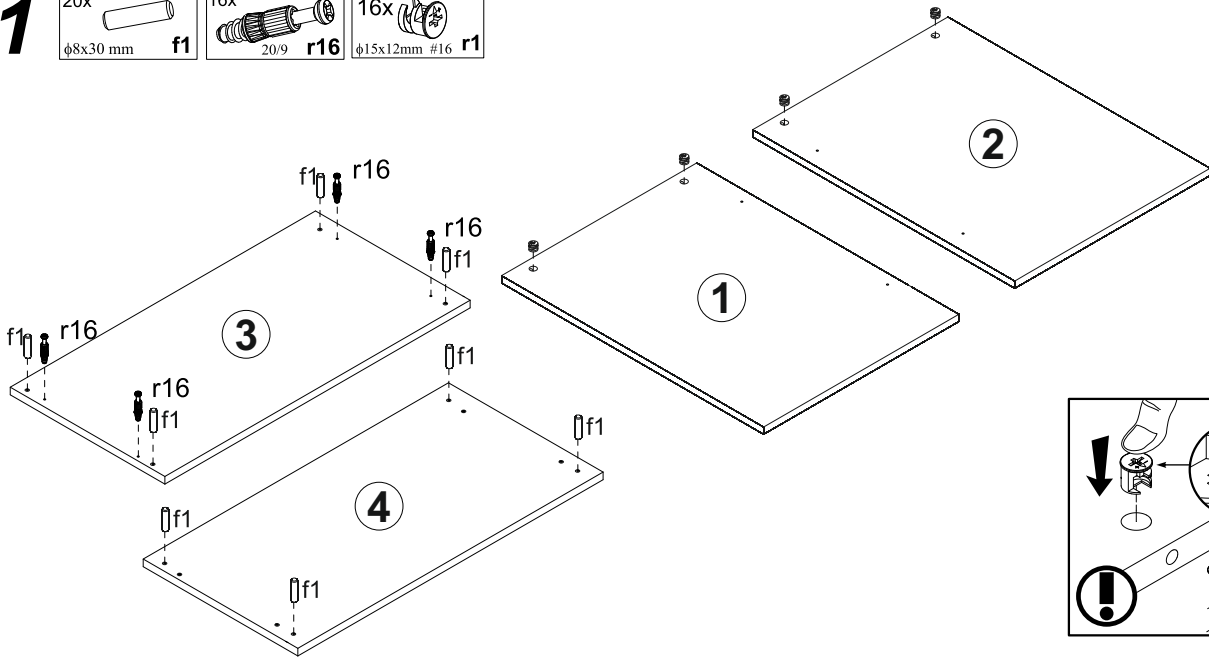

# 2

4x  
φ7x50 mm e32

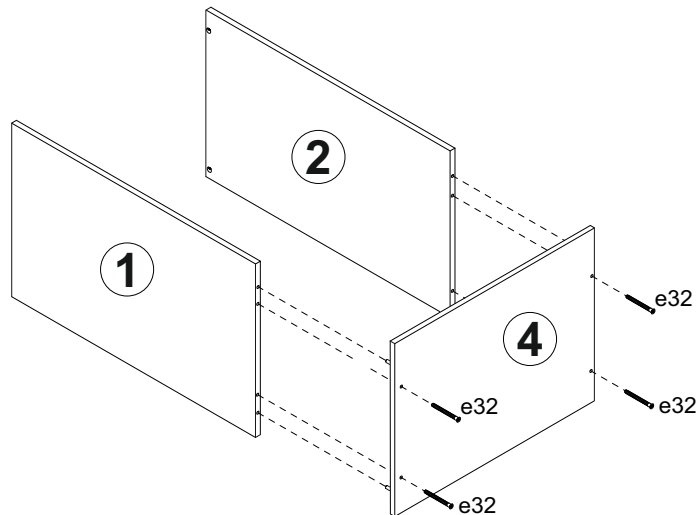

# 3

4x  
15x10x14mm c14

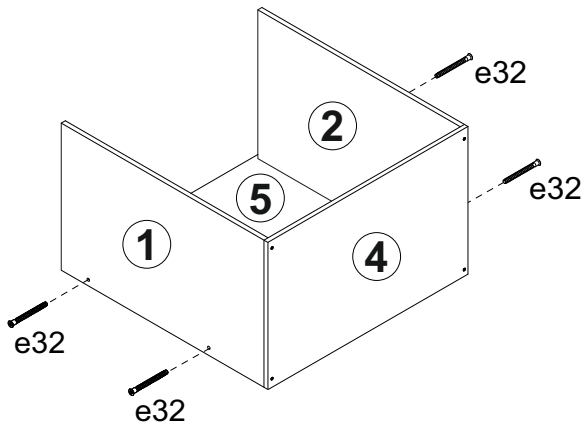

# 4

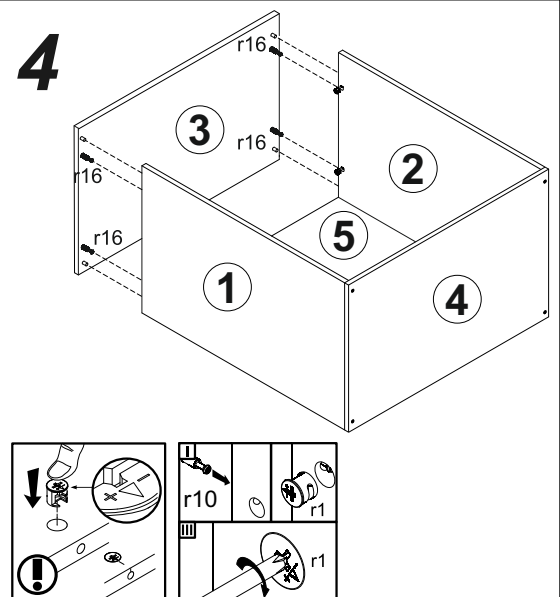

# 5

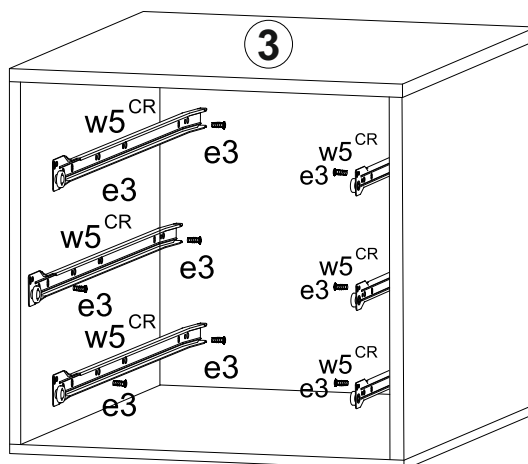
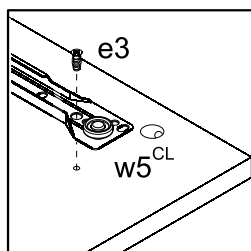
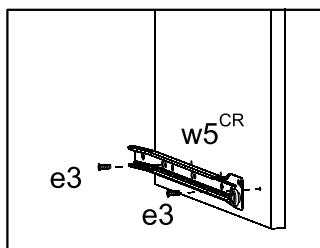
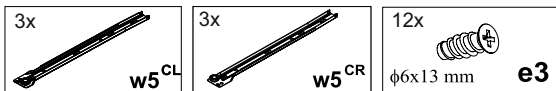

# 5

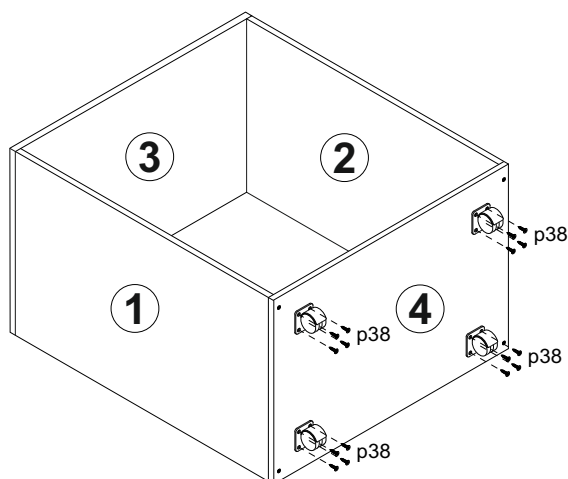

# 7

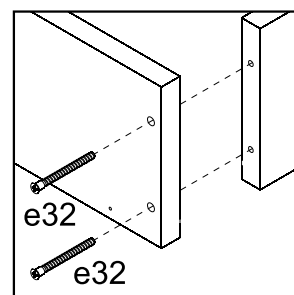
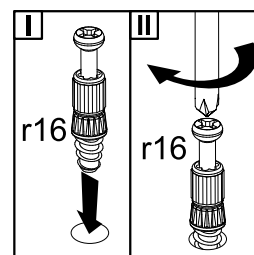
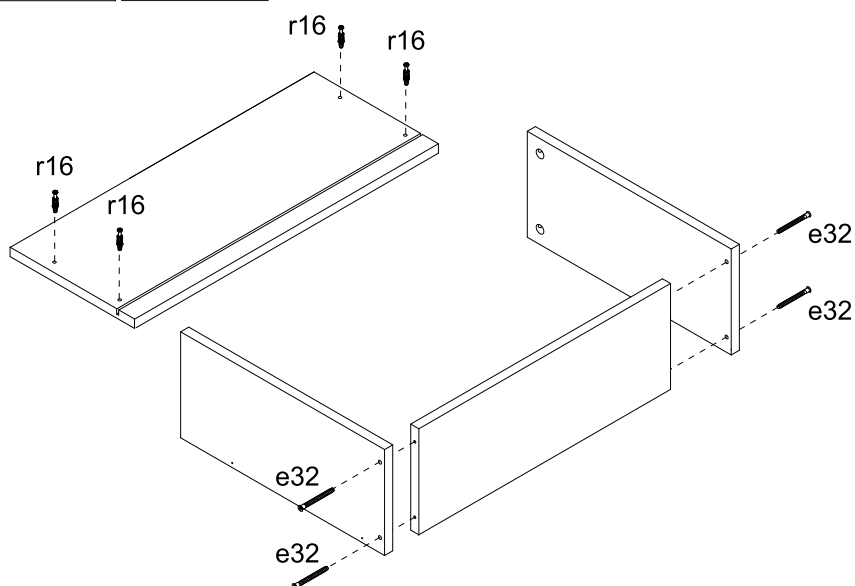
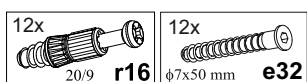

# 8

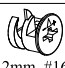
12x  
  
 ϕ15x12mm #16 **r1**

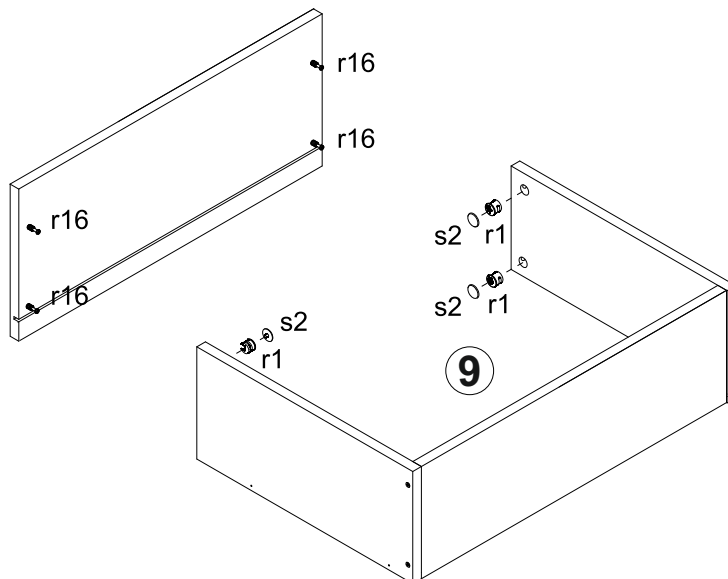

# 12

12x  
  
 ϕ3,5x16 mm **p38**

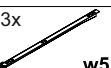
3x  
  
**w5<sup>DL</sup>**

3x  
  
**w5<sup>DR</sup>**

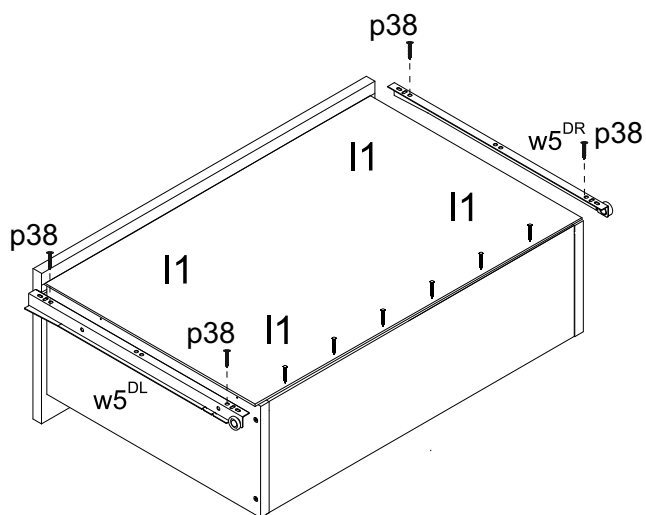

# 10

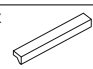
2x  

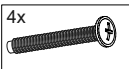
4x  

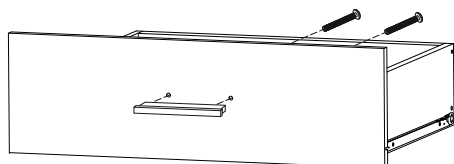

Place washers over the screws  
 to hold the handles securely.  
**Washers can be found in the hardware kit.**

# 11

